

EJSD FY'13 Budget

1st Draft – January 26, 2012

Contents:

- EJSD General & Capital Plan
- EJRP General & Capital Plan



Board Guidance

EJSD General Fund

Maintain the high level of educational quality presently found in the District

Support the essential elements of the School Action Plan analyzing current practices as well as unfunded requirements and adjusting as necessary for enrollment

Be sensitive to the burden on tax payers by presenting a proposed budget with a minimal increase to education spending

EJSD Capital Fund

Propose continued, responsible reductions. Make recommendations relating to the depletion of the Capital Reserve Fund and how it will impact the taxpayer

EJRP General Fund

Level Tax Rate – Propose a balanced budget with the Property Tax revenue being calculated off the current municipal tax rate.

EJRP Capital Fund

Propose a Capital Plan constrained by \$75,000 per year.



At A Glance

■ EJSJ General Fund

- Total budget = **\$16,441,314**
- Education Spending shows an **increase** of \$269,349 or **2.1%**, but is lower than FY'11
- Includes larger than usual budget-to-budget salary increases

■ EJSJ Capital Plan

- Total budget = **\$237,000** – reflects a **decrease** of \$24,000 or **-9.2%**

■ EJRP General Fund

- Total budget = **\$1,559,558**
- Represents an **increase** of \$50,592 or **3.4%**
- Constrained by **level tax rate** (\$0.0651)
- About 60% of the budget is funded by program revenues

■ EJRP Capital Plan

- Total budget = **\$75,000** – held at current level

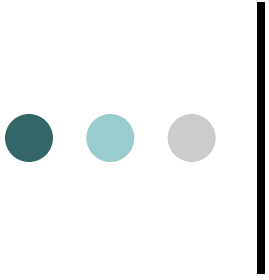

EJSD General Fund



Summit Achievements

■ School

- Celebrating its 60th year educating Essex Junction's children!
- Utilizing videoconferencing and Virtual Field Trips for activities such as viewing animals at the Bronx Zoo to learn about animal adaptation, viewing "Polar Bears International" from Manitoba, Canada, visiting a station to learn about Weather Science, etc. Children ask questions and learn first-hand from scientist working in the field.
- Standards-based teaching and learning is evidenced by revised report cards aligned with the CCSU Power Standards to ensure consistency between grade level classes for K-5 students and their parents.
- Natural Playground Committee secured funds to pay for the design of a playground for the school and community at large. Steps are in progress to make this design a reality in the upcoming years.

■ Students

- After introducing the Six Pillars of Character as a means to reinforce positive behaviors, hundreds of students have been recognized at school assemblies as Stars of the Week for displaying positive characteristics such as: Trustworthiness, Respect, Responsibility, Fairness, Caring, Citizenship.
- 57% of last year's third graders were awarded the highest level of Achievement with Distinction on the Mathematic NECAP assessment.
- Students in several classrooms were involved in a special project to publish a book and digital stories entitled: Playgrounds Around the World; this was a culmination of connections made via Skype and video conferencing with schools in Hawaii, Honduras, Alaska, and Kentucky, just to name a few.

■ Staff

- Regina Sewell (Special Educator) was asked to serve on the VT Response to Intervention (RTI) Steering Committee charged by the DOE to develop policy level guidelines for what RTI should look like in Vermont.
- Meghan Turcot (2nd Grade Teacher) and Katherine Duggan (Learning Center Director) created Blogs to communicate with parents and children.
- Under the leadership of Jade Hazard (math educator), the Dynamic Indicators of Basis Early Literacy Skills (DIBELS) Math Universal Screening is being piloted by K-3 educators as a data point to inform instruction and programming.



Hiawatha Achievements

■ School

- Began the school year with a new main entrance, lobby, and main office suite – positive feedback from everyone
- The prekindergarten program was recognized in September 2011 as a four-star program as measured by criteria established by the State's Department of Children & Families
- Nearly every learning place within the schoolhouse now employs a SmartBoard as a means of integrating technology with instruction

■ Students

- The percentage of socio-economically disadvantaged children meeting NECAP reading & math standards has almost doubled since 2006
- Nearly 80% of students participated in fundraising efforts for a local food shelf and for the Hurricane Irene Relief Fund
- Two artist in residence projects are nearing completion in support of the fine art's curriculum including a mural project utilizing recycled materials and a dance project celebrating diversity
- Third grade students participated in the 1st school-wide community service work project – volunteering break time to perform community service within the schoolhouse

■ Staff

- Mary Beth Funtow was recognized as the CCSU Elementary Teacher of the Year – sponsored by the UVM Teacher Recognition Program
- Tom Bochanski was recognized as Vermont's 2011 National Distinguished Principal – sponsored by the National Association of Elementary School Principals



Fleming Achievements

■ School

- Celebrating the 100th year of learning in our wonderful facility - events planned for the week of June 1-9
- Successfully implemented new Vertical House Teams to enhance collaborative teaching & learning opportunities
- Offering an intramural program option on Tuesdays & Thursdays after school in response to healthy schools assets survey results.

■ Students

- Conducted fund raisers and a book drive to provide Hurricane Irene flood relief to four communities and also sent banners & cards
- Over 40 students are participating in the Math Olympiad Program after school
- 60% of students are participating in the school instrumental music program
- The Fleming Spelling Team participated and achieved competitive success in the VPA Regional Spelling Bee. This fifth grade team competed against 5th/6th grade middle school teams in the region .
- The Fleming School Geography Bee Champions have qualified for the Vermont State National Geographic Geo Bee every year since 2001
- The Fleming Dance Team champions performed at UVM as a fundraiser for the University's athletic programs

■ Staff

- Teachers participated in Responsive Classroom consultation & coaching sessions with a focus on Academic Choice
- Teachers have dedicated meeting and coaching time to work with a literacy consultant to further their knowledge and use of the Fountas & Pinnell assessment program
- Teachers are continuing grade level work with a math consultant to model new instruction & assessment techniques
- Teachers have continued their work with formative assessment in the area of writing quality constructive responses. This cross-curriculum, thinking through writing, schoolwide focus has resulted in improvement and steady growth.



ADL Achievements

■ School

- Continued focus on co-teaching in language arts & math, differentiated instruction, standards-based planning, assessing & reporting, and curriculum mapping
- Continued focus on technology integration, next generation skills, and a vision for technology use & information literacy for students and educators
- Proud of our many after school events such as: Holiday Concert, Annual Diversity Day, Annual Empty Bowls Night, Annual Basketball Tourney (#42 this year!), Annual Musical, etc. – always well-attended and provide important life lessons

■ Students

- Nate Baliff and Hannah Couture were recognized by the NE League of Middle Schools & VT Association of Middle Level Educators as ADL's Middle Level Scholar Leaders
- Kirk Teare won 1st place in the Annual Peace Poster contest sponsored by the Lion's Club
- Each student shared in the responsibility of creating a school-wide social contract – posted in the cafeteria
- ADL's chorus, band and orchestra programs comprise more than 2/3rds of the student body
- Significantly raised our 8th grade science NECAP scores over the last two years; well above the state average

■ Staff

- Teachers worked with a Differentiated Instruction consultant to review professional development needs
- Participating in monthly co-teaching professional development
- 17 educators participated in a Developmental Design class (similar to Responsive Classroom, but for middle school)
- Teachers are working with colleagues from Essex High School to utilize an IBM grant and mentorship to plan for implementation of Science, Technology, Engineering, & Math (STEM) and STEAM (integrating the Arts) at ADL
- Amanda Eldridge was a recipient of the Positive Youth Sports Alliance Coach of the Year
- Laurie Singer was the recipient of the National Association of Secondary School Principals and John Winton Middle Level Educator of the Year Award for VT



FY'13 Considerations

- **Year following large reductions for ‘Challenges for Change’**
- **FY'12 budget assumed ‘steps-only’ settlement**
- **Large FY'11 surplus - \$948K**
- **Use of Education Jobs Fund - \$79.5K**
- **‘Two-Vote’ Threshold**

FY'13 Fund
Balance
Revenue
(\$750K)

- Level revenue requires \$600K
- Budget-to-budget salary increase (assumption vs settlement) - \$150K
- Article to commit \$198K for lower than anticipated future revenues to add to the existing \$190K

Educational Quality – Multi-year

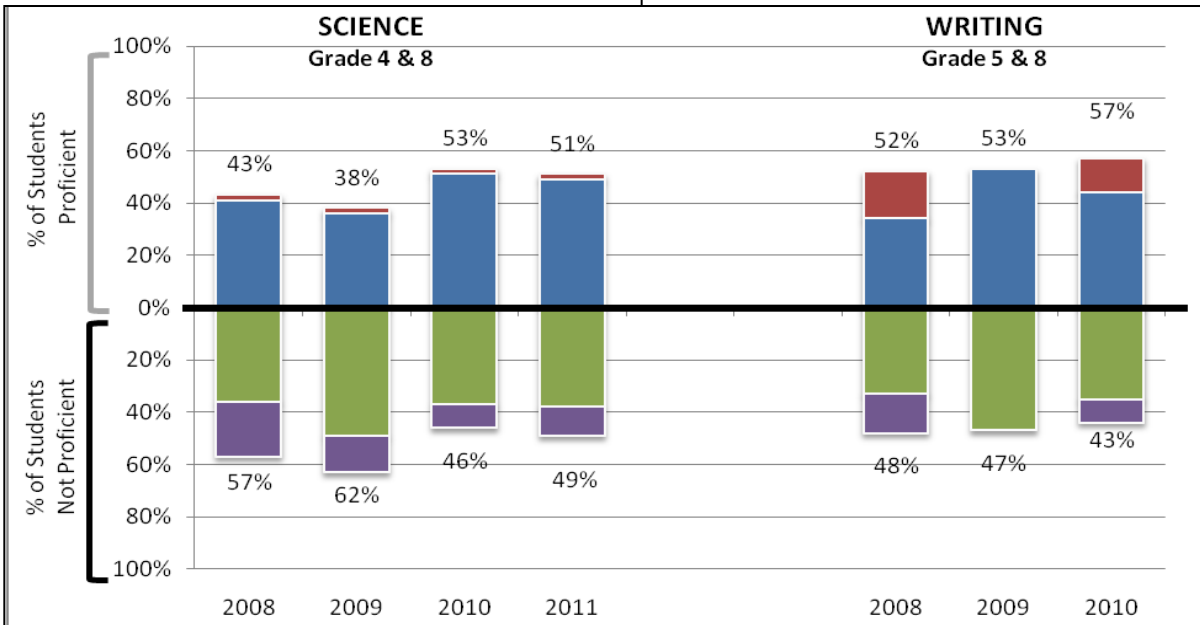
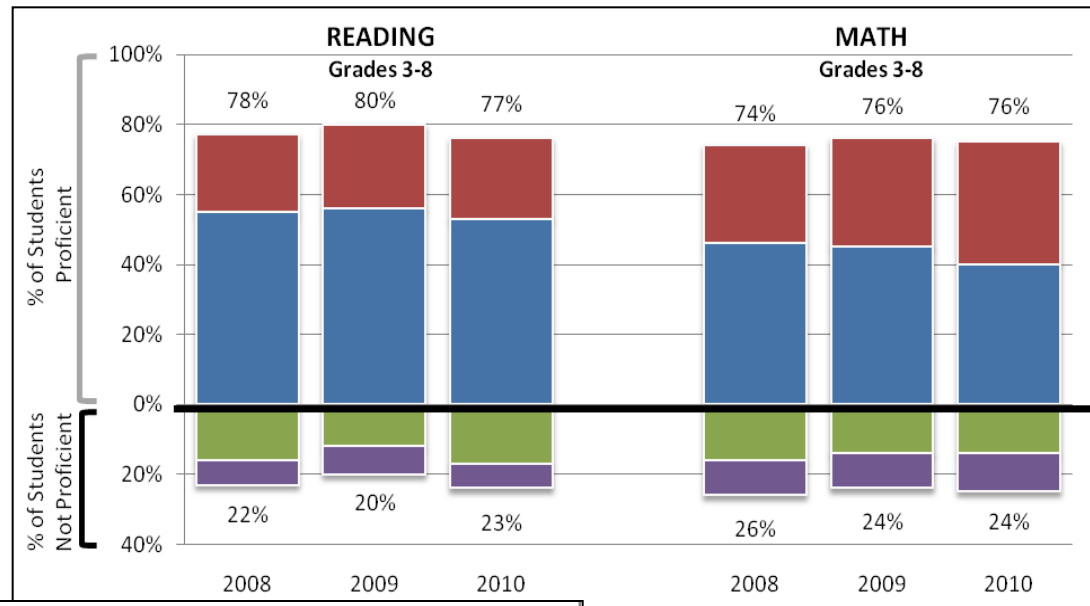

- Proficient with distinction
- Proficient
- Partially proficient
- Substantially below proficient

Educational Quality – Comparison

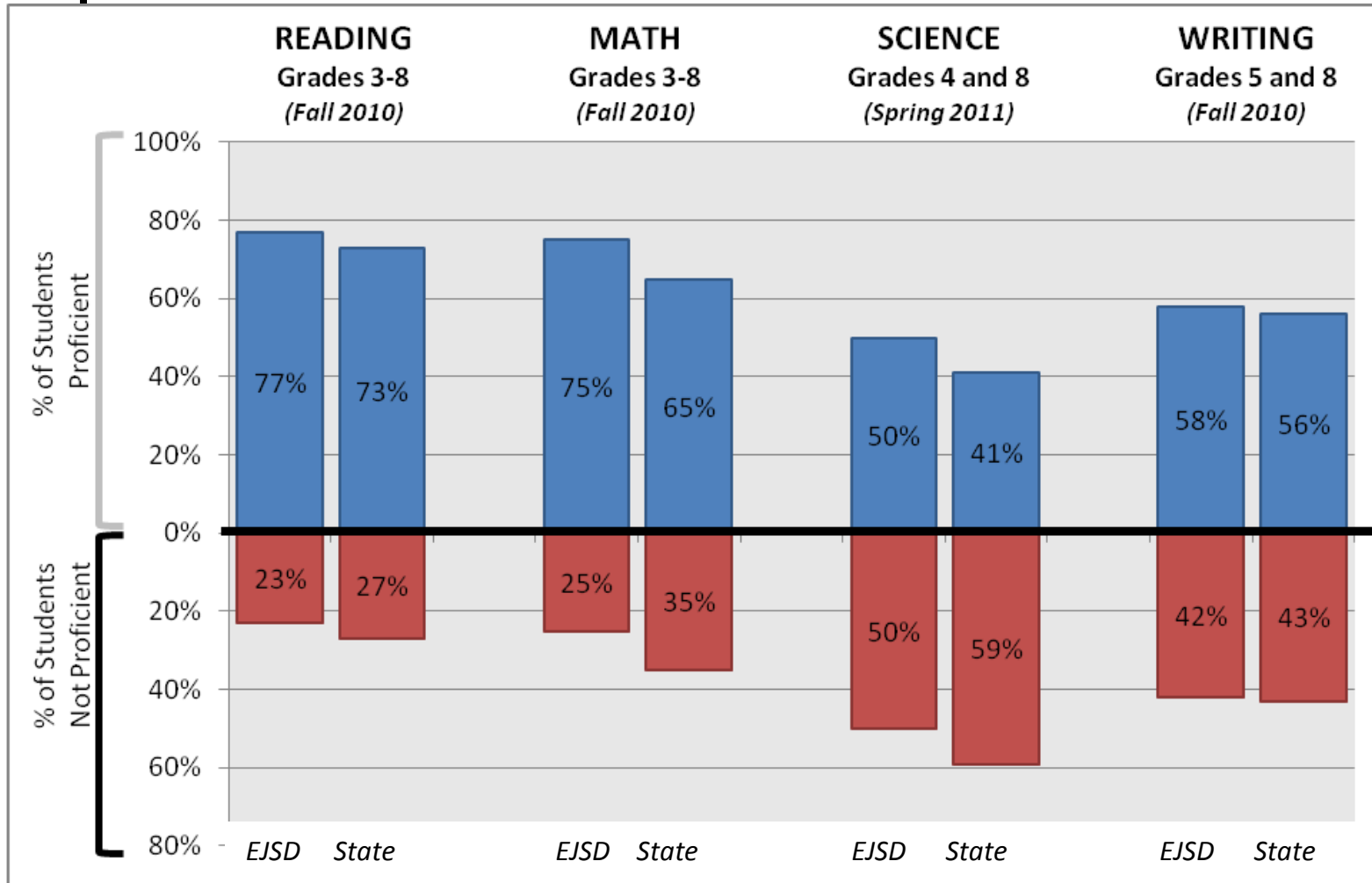

EJSD Enrollment Projections

Enrollment Projection

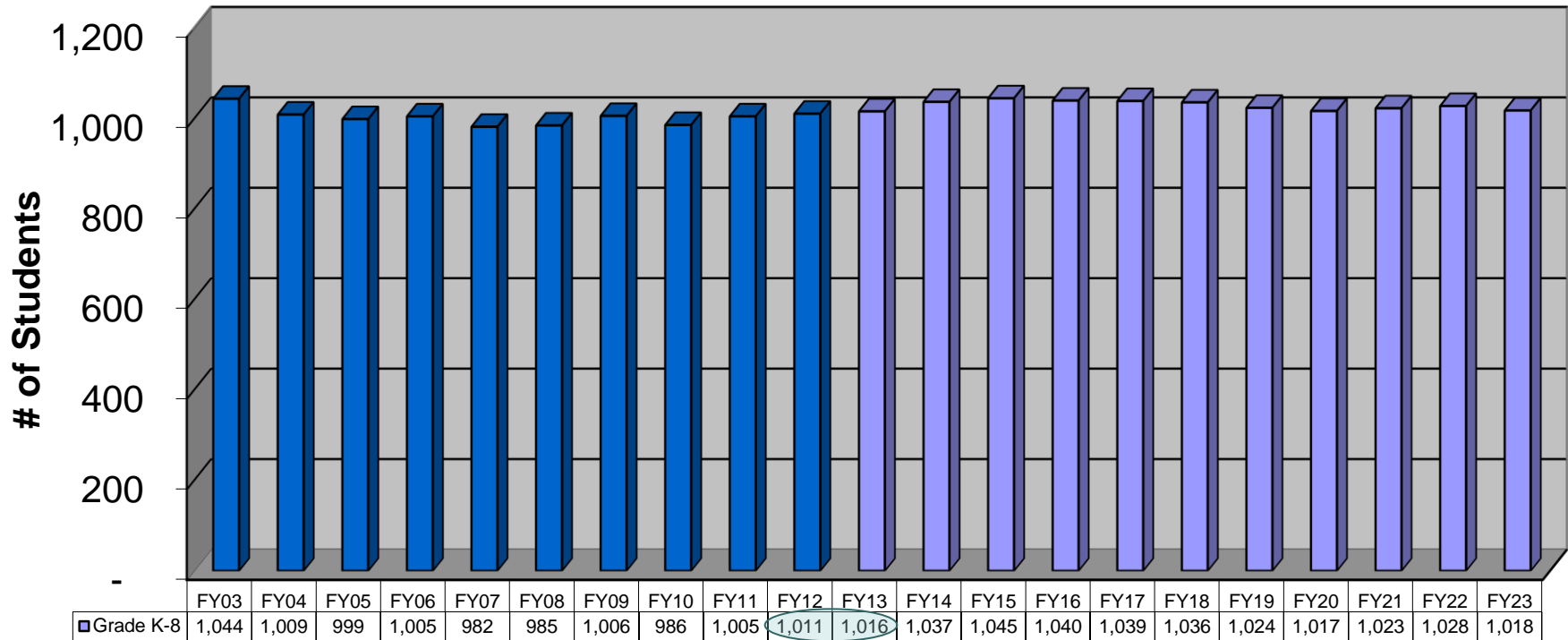

- FY'12 projection was 1,011 and the Oct 1 count was 1,011 (0.0% variance)
- Projection shows an increase in the next few years which ends up leveling off around 1,025 over the next decade

Budget Overview

Description	FY'11	FY'12	FY'13	Change	% Change
Total Expense Budget	\$16,004,189	\$15,743,203	\$16,441,314	\$698,111	4.4%
- Non-Tax Revenue	\$2,787,141	\$2,822,206	\$3,250,968	\$428,762	15.2%
+ Capital Fund Contribution	\$100,000	\$100,000	\$100,000	\$0	0.0%
= Education Spending (ES)	\$13,317,048	\$13,020,997	\$13,290,346	\$269,349	2.1%
÷ Equalized Pupil (EP) Count	998.75	1,013.26	1,027.27	14.01	1.4%
= ES/EP	\$13,333.72	\$12,850.60	\$12,937.54	\$86.94	0.7%
÷ Base Education Amount	\$8,544.00	\$8,544.00	\$8,723.00	\$179.00	2.1%
= District Spending Adj (ES/EP / Base Ed Amt)	156.059%	150.405%	148.315%	-2.090%	

Ed Spending lower than FY'11

Ballot article amount

Assumption - requires Legislative action

Slight increase in Education Spending

Key factor in tax rate calculation

Act 82 – Two Vote Requirement

The answer to both questions must be "YES" to require 2nd vote	
1. Did prior year ES/EP exceed the prior year state average?	YES
FY'12	
Education Spending Per Equalized Pupil (ES/EP)	\$ 12,850.60
State-wide average	\$ 12,287.46
2. Does the proposed ES exceed the MIA?	NO
FY'13	
Proposed Budget	
Expense Budget	\$ 16,441,314
- "Local" Revenues	\$ 3,250,968
+ Capital Fund Contribution	\$ 100,000
= Education Spending	\$ 13,290,346
Maximum Inflation Amount	
Essex Junction SD prior year ES/EP	\$ 12,850.60
+ Inflation index (3.1% * FY'12 state average)	\$ 380.91
= MIA per EP	\$ 13,231.51
* Equalized Pupils (can use current or prior)	1,027.27
= District's Maximum Inflation Amount	\$ 13,592,333
Is a 2nd vote be required?	NO

Excess Spending Threshold

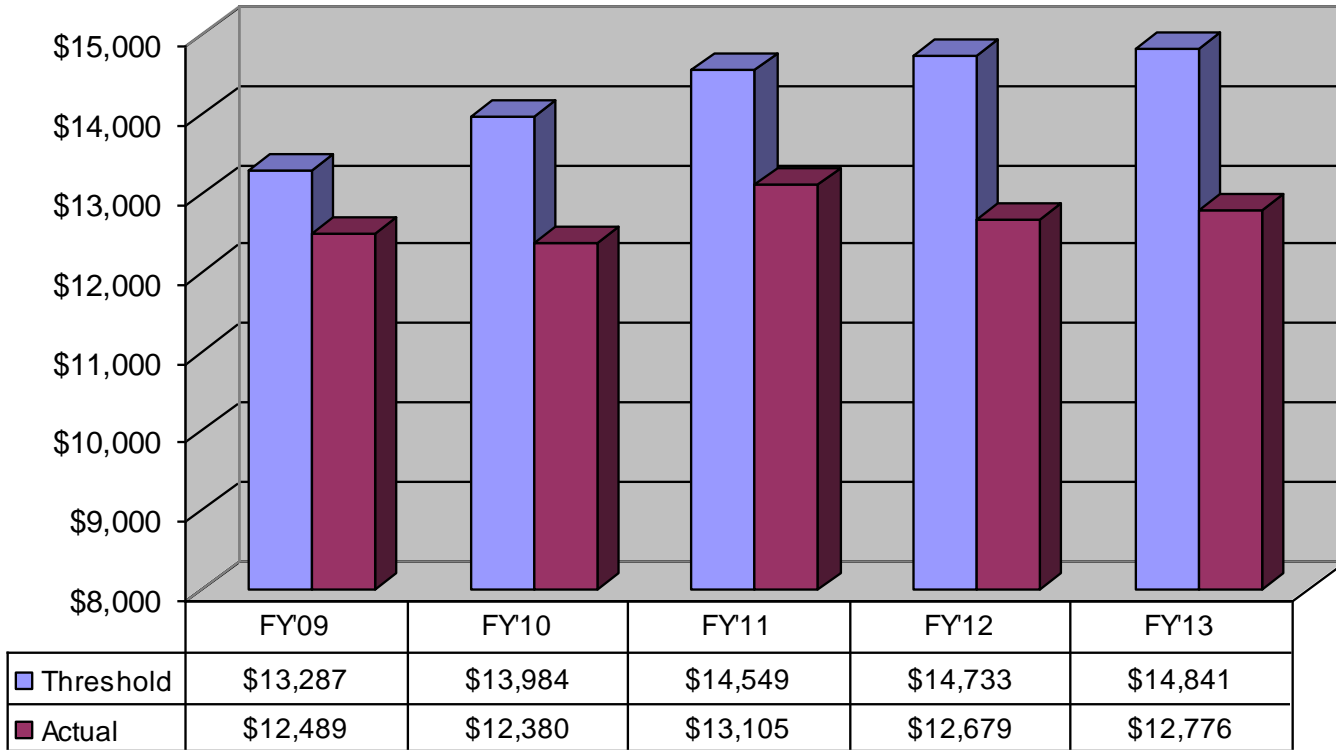

The “Actual” amount differs from Education Spending per Equalized Pupil because eligible construction costs are backed out.

Overview – Revenues (\$16.4M)

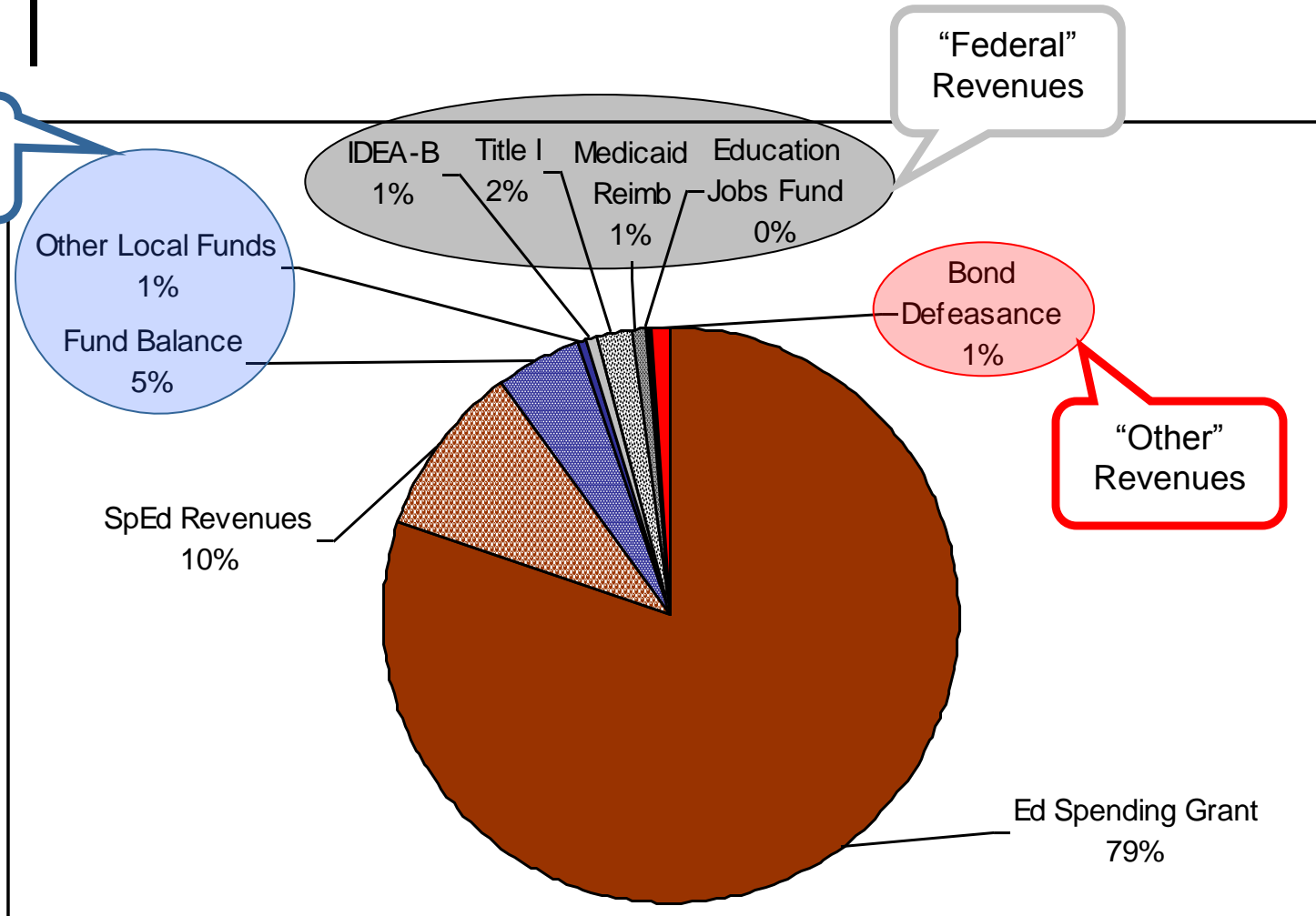

Revenues

SecName	DESCRIPTION	Sum of FY'10 ACTUALS	Sum of FY'11 ACTUALS	Sum of FY'12 APPROVED	Sum of FY'13 PROPOSED	Sum of \$ Change	Comments
LOCAL	Fund Balance	\$0	\$0	(\$600,000)	(\$750,000)	\$150,000	See Fund Balance slide
	Shared Costs	(\$40,000)	(\$40,000)	(\$40,000)	(\$40,000)	\$0	For Mechanic's Garage & Park St School
	Tax Penalties/Interest	(\$51,447)	(\$42,711)	(\$35,000)	(\$35,000)	\$0	
	Interest Earnings	(\$6,285)	(\$6,475)	(\$10,000)	(\$7,000)	(\$3,000)	In line w/ actuals
	Building Rental	(\$1,306)	(\$558)	(\$2,000)	(\$1,000)	(\$1,000)	
	Regular Elem Tuition	(\$36,176)	(\$25,000)	\$0	(\$12,500)	\$12,500	One ADL student anticipated
LOCAL Total		(\$135,215)	(\$114,744)	(\$687,000)	(\$845,500)	\$158,500	
STATE	Education Spending Grant	(\$12,530,507)	(\$12,765,488)	(\$12,920,997)	(\$13,190,346)	\$269,349	Balances revs & exp - minor tax impact
	Special Ed Mainstream Block Grant	(\$353,684)	(\$342,223)	(\$340,814)	(\$350,040)	\$9,226	DOE estimate
	Special Ed - Expenditures Reimbursement	(\$1,016,994)	(\$1,311,248)	(\$1,013,119)	(\$1,159,726)	\$146,607	DOE estimate
	Special Ed - State Placed Reimburse	(\$4,867)	(\$1,000)	\$0	(\$6,000)	\$6,000	Based on service plan requirements
	Essential Early Education (EEE)	(\$112,505)	(\$97,058)	(\$98,742)	(\$106,987)	\$8,245	DOE estimate
	State Transportation Aid	(\$1,840)	(\$545)	\$0	\$0	\$0	
STATE Total		(\$14,020,397)	(\$14,517,563)	(\$14,373,672)	(\$14,813,099)	\$439,427	
FEDERAL	IDEA-B	(\$149,476)	(\$40,000)	(\$104,084)	(\$102,200)	(\$1,884)	
	IDEA B - Preschool	(\$12,850)	(\$13,039)	(\$13,223)	(\$13,223)	\$0	
	Title I - Basic & Concentration Grants	(\$249,715)	(\$203,910)	(\$209,409)	(\$307,804)	\$98,395	Amount needed to fund current staffing levels for Math specialists & tutors - Risk area
	Medicaid Reimbursement (IEP)	(\$94,150)	(\$124,445)	(\$108,015)	(\$112,957)	\$4,942	Funds Social Workers
	Education Jobs Fund	\$0	(\$77,259)	(\$72,800)	(\$79,531)	\$6,731	To offset Act 62 agreements
	Ed Spending Grant - ARRA	(\$445,627)	(\$454,423)	\$0	\$0	\$0	
	IDEA-B ARRA	(\$37,244)	(\$32,954)	\$0	\$0	\$0	
	IDEA-B Preschool ARRA	(\$11,990)	(\$1,240)	\$0	\$0	\$0	
	Title I ARRA	(\$131,944)	\$0	\$0	\$0	\$0	
FEDERAL Total		(\$1,132,996)	(\$947,270)	(\$507,531)	(\$615,715)	\$108,184	
OTHER	Fund Transfer In	(\$237,935)	(\$227,771)	(\$175,000)	(\$167,000)	(\$8,000)	Bond Defeasance fund
	Prior Year Adjustments	(\$32,947)	\$0	\$0	\$0	\$0	
	Copier Rental	(\$70,492)	(\$70,492)	\$0	\$0	\$0	
	Miscellaneous Income	\$0	(\$2,210)	\$0	\$0	\$0	
	VSBIT Refund	\$0	(\$8,929)	\$0	\$0	\$0	
OTHER Total		(\$341,375)	(\$309,403)	(\$175,000)	(\$167,000)	(\$8,000)	
Grand Total		(\$15,629,983)	(\$15,888,980)	(\$15,743,203)	(\$16,441,314)	\$698,111	



\$19M Federal Education Jobs Fund (EJF)

- Federal intent: Save or create education jobs
- State intent: Bridge to achieve C4C targets in FY'12
- EJSD allocated \$229,590 – must be used for salary & benefit costs, but can free up money for other requirements
- Funds are available from now until September 2012 (FY'13)
- EJSD chose to use the EJF money in a way that would result in future year tax benefits
 - Avoids negative tax rate implications when revenue dries up
 - Guards against a future tax increase
- Funds were used to expand private preschool agreements to expand preschool opportunity and increase the equalized pupil count
 - Full equalized pupil impact isn't seen for three years
 - \$150,058 was used in FY'11 and FY'12
 - Balance of \$79,531 is proposed for same use in FY'13



Fund Balance

FY'11 Surplus (Deficit)		\$948,134.80
+ Revenues	\$20,377,241.54	
+ Transfers In	\$227,771.16	
- Expenditures	\$20,206,877.90	
- Transfers Out	\$0.00	
+ FY'11 Fund Balance	\$550,000.00	
Recommendation (authority of electorate)		\$948,000.00
Utilize as FY'13 fund balance revenue	\$750,000.00	
Commit for lower than anticipated future revenue	\$198,000.00	

■ FY'11 Surplus was \$948K

- **Uses \$750K as a revenue source**
 - \$150K higher than usual, but covers higher than usual budget-to-budget salary increase
- **Proposes to commit \$198K for lower than anticipate revenues in future years**
 - Adds to current balance of \$190,346
 - Guards against fund balance drop in FY'14 by covering FY'12 settlement impact and ensuring there isn't a deficit

Overview – Investments (\$16.4M)

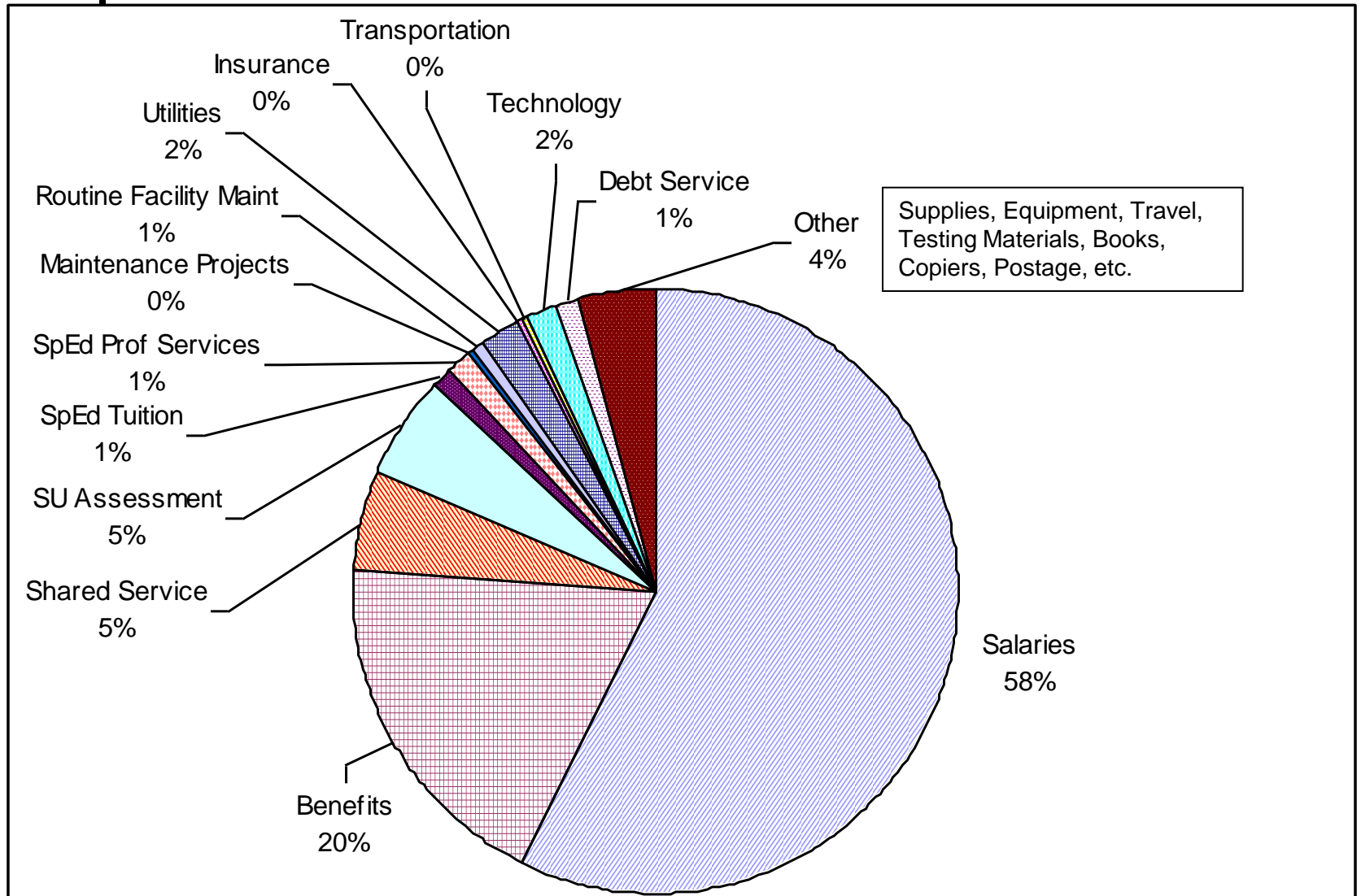

Budget Overview

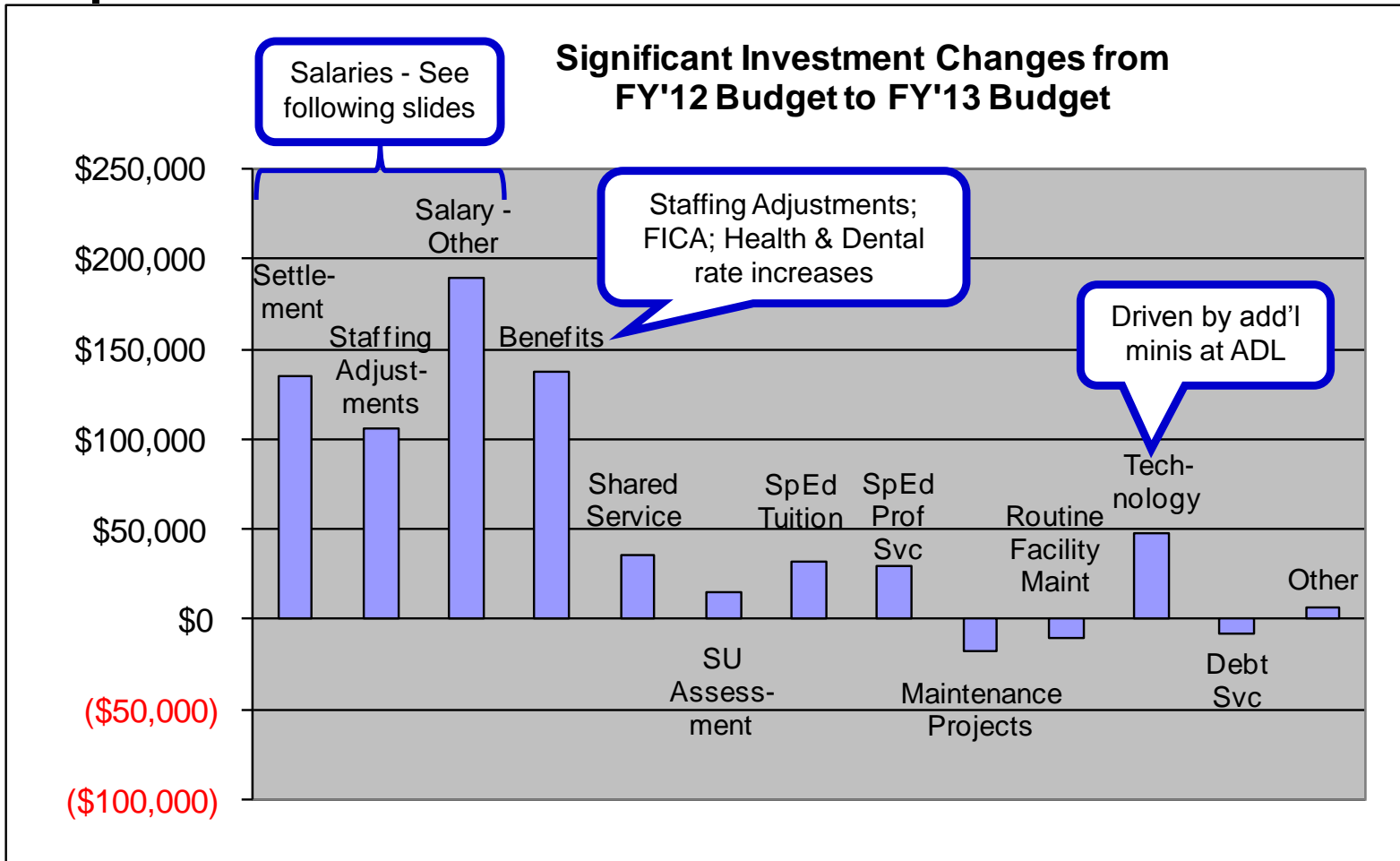

Investments (1 of 8)

FncName	DESCRIPTION	Sum of FY'10 ACTUALS	Sum of FY'11 ACTUALS	Sum of FY'12 APPROVED	Sum of FY'13 PROPOSED	Sum of \$ Change	Comments
Personnel & District Wide	Certified Staff Salaries	\$7,162,389	\$7,242,437	\$7,293,484	\$7,477,117	\$183,633	See Staffing Adjustments
	Support Staff Salaries	\$1,416,200	\$1,516,710	\$1,164,655	\$1,368,896	\$204,241	See Staffing Adjustments
	Substitute Teachers	\$286,387	\$297,831	\$290,840	\$290,840	\$0	
	Certified Staff Retirements	\$54,000	\$46,000	\$57,000	\$100,000	\$43,000	5 early departures in FY'12 & an add'l 6 in FY'13
	Extra Curricular Activity Stipends	\$65,292	\$70,134	\$67,915	\$73,240	\$5,325	Establish AD at ADL
	Tutoring Salaries	\$40,110	\$45,827	\$51,242	\$43,950	(\$7,292)	
	Overtime Salaries	\$39,262	\$50,579	\$15,718	\$15,718	\$0	
	Certified Staff Extra Duty	\$16,634	\$3,075	\$16,054	\$16,337	\$283	
	Board Stipends	\$5,000	\$5,000	\$5,000	\$5,000	\$0	
	Social Security (FICA)	\$679,067	\$693,715	\$685,600	\$718,444	\$32,844	
	Health Benefits	\$1,779,424	\$1,766,457	\$1,820,764	\$1,910,551	\$89,787	VSBIT 3.5% rate increase
	Catamount Health	\$10,443	\$18,256	\$12,423	\$16,312	\$3,889	
	Health Inoculations	\$231	\$246	\$200	\$200	\$0	
	Dental Insurance	\$145,755	\$157,487	\$151,419	\$168,332	\$16,913	6% rate increase - 1st in 10 yrs
	Group Life Insurance	\$14,333	\$14,553	\$14,003	\$14,474	\$471	
	Retirement Contributions	\$72,666	\$78,075	\$71,680	\$72,383	\$703	
	Tuition Reimbursement	\$114,419	\$107,260	\$122,844	\$119,496	(\$3,348)	Inflated FY'11 actuals
Unemployment Compensation	\$3,853	\$11,892	\$13,477	\$13,477	\$0		
Workers' Compensation	\$56,406	\$67,629	\$74,846	\$71,331	(\$3,515)	More in line with actuals	
Personnel & District Wide Total		\$11,961,872	\$12,193,166	\$11,929,164	\$12,496,098	\$566,934	

Staffing Adjustments

Budget Adjustment	Position Description	FTE Adj	\$ Adj
FY'12: Increased Title I Funding	MATH SUPPORT SPECIALIST	0.50	\$30,145
	TITLE I MATH TUTOR	2.00	\$58,891
FY'13: Projected Student IEP Need	INTERVENTIONIST	1.00	\$38,015
FY'13: New - TA Support (w/ EJRP)	MAINSTREAM TA	1.50	\$47,682
FY'13: Athletic Director	ASSISTANT PRINCIPAL	-0.08	(\$8,380)
	ATHLETIC DIRECTOR	1.00	\$2,936
Total Adjustment		5.92	\$169,289

■ Title I Math Support

- The positions noted above were added in FY'12 as a result of receiving more Title I funds than anticipated and the proposed budget maintains the same staffing level
- Total Title I math support proposed is 2.5 specialists and 3 tutors
- If less than anticipated funding is received in FY'13, all positions can be covered by General Funds or tutor positions can be eliminated

■ Interventionist

- Requirement driven by student need

■ TA Support (w/ EJRP)

- 3 full-time positions are being proposed with funding split between EJSJ and EJRP
- EJSJ funds would be used to fund 3 part-time positions at Hiawatha, Summit, and Fleming to act as regular education TAs to provide coverage for lunch, recess, etc.

■ ADL Athletic Director (AD)

- Removes AD responsibilities from Assistant Principal (AP) position – AP becomes an extended school-year position and AD becomes a stipend position

Investments (2 of 8)

FuncName	DESCRIPTION	Sum of FY'10 ACTUALS	Sum of FY'11 ACTUALS	Sum of FY'12 APPROVED	Sum of FY'13 PROPOSED	Sum of \$ Change	Comments
Direct Instruction	Audiovisual Materials	\$1,641	\$480	\$1,450	\$1,150	(\$300)	
	Books	\$13,129	\$12,460	\$14,025	\$13,925	(\$100)	
	Dues & Fees	\$471	\$657	\$935	\$720	(\$215)	
	Equipment	\$95,827	\$96,145	\$14,118	\$12,890	(\$1,228)	
	General Maintenance	\$970	\$841	\$1,250	\$1,450	\$200	
	General Supplies	\$134,613	\$130,923	\$133,366	\$139,565	\$6,199	Increase driven by hallway cubbies & new sign @ HIA
	Miscellaneous Expense	\$0	\$80	\$0	\$0	\$0	
	Other Professional Services	\$5,368	\$6,018	\$6,350	\$4,200	(\$2,150)	
	Periodicals	\$2,102	\$1,353	\$1,960	\$2,140	\$180	
	Printing & Binding	\$85	\$0	\$300	\$0	(\$300)	
	Professional Education Services	\$2,640	\$4,408	\$7,500	\$6,500	(\$1,000)	
	Rental of Equipment	\$11,278	\$9,222	\$9,000	\$9,000	\$0	Copier lease & contract
	Rentals & Leases	\$34,046	\$33,527	\$29,400	\$29,250	(\$150)	Copier lease & contract
	Student Special Programs	\$10,749	\$8,593	\$13,800	\$14,050	\$250	
	Technology Hardware	\$7,993	\$1,778	\$1,800	\$200	(\$1,600)	Digital camera - all other rqmts in Technology budget
	Technology Software	\$6,677	\$9,780	\$16,625	\$15,405	(\$1,220)	Discovery Streaming, Lexia Reading, Science Discovery, Math s/w, etc.
	Testing Materials	\$2,284	\$0	\$8,700	\$5,450	(\$3,250)	Local assessments
	Travel & Conference	\$4,503	\$2,236	\$9,330	\$9,200	(\$130)	PD rqmts such as literacy/math conferences and VT Tech Fest
Tuition to Other VT Schools	\$0	\$0	\$2,500	\$0	(\$2,500)	Was a set-aside for home-schooling	
Tuition to Private Schools	\$26,561	\$32,499	\$106,600	\$106,600	\$0	Private preschool agreements	
Direct Instruction Total		\$360,939	\$351,000	\$379,009	\$371,695	(\$7,314)	

Investments (3 of 8)

FuncName	DESCRIPTION	Sum of FY'10 ACTUALS	Sum of FY'11 ACTUALS	Sum of FY'12 APPROVED	Sum of FY'13 PROPOSED	Sum of \$ Change	Comments
Special Education	Advertising	\$343	\$578	\$400	\$550	\$150	
	Audiovisual Materials	\$295	\$0	\$0	\$0	\$0	
	Books	\$1,722	\$2,404	\$3,375	\$3,125	(\$250)	
	Equipment	\$3,192	\$4,758	\$3,620	\$2,950	(\$670)	
	Excess Costs	\$0	\$0	\$0	\$0	\$0	
	General Maintenance	\$0	\$187	\$0	\$200	\$200	
	General Supplies	\$13,565	\$22,029	\$12,525	\$15,775	\$3,250	More in line w/ actuals
	Other Professional Services	\$190,259	\$227,993	\$189,281	\$219,184	\$29,903	Social Wkrs up \$5K (\$90K); Psych Evals up \$15K (\$73K); OT/PT up \$5K (\$29K); EEE OT/PT & Psych (\$26K)
	Periodicals	\$0	\$0	\$100	\$100	\$0	
	Postage	\$97	\$88	\$100	\$100	\$0	
	Printing & Binding	\$0	\$0	\$300	\$300	\$0	
	Student Special Programs	\$390	\$672	\$400	\$600	\$200	
	Technical Services	\$0	\$0	\$1,000	\$500	(\$500)	
	Technology Hardware	\$4,647	\$2,494	\$5,670	\$3,950	(\$1,720)	3 iPads @ SUM, digital media players @ FLE, 2 laptops @ ADL
	Technology Software	\$1,166	\$1,487	\$5,823	\$6,408	\$585	
	Telephone	\$85	\$604	\$1,680	\$1,700	\$20	
	Testing Materials	\$2,005	\$1,674	\$2,900	\$3,350	\$450	
	Travel & Conference	\$209	\$818	\$300	\$600	\$300	
	Tuition to Other VT Schools	\$164,063	\$177,783	\$173,982	\$206,582	\$32,600	Based on service plan - anticipated student needs
Special Education Total		\$382,038	\$443,570	\$401,456	\$465,974	\$64,518	
Co-Curricular & Athletics	Dues & Fees	\$100	\$135	\$720	\$730	\$10	
	Equipment	\$420	\$0	\$0	\$0	\$0	
	General Supplies	\$3,208	\$3,291	\$4,020	\$2,950	(\$1,070)	Reduction for ADL clubs - more in line w/ actuals
	Officials' Fees	\$5,940	\$6,625	\$6,440	\$6,940	\$500	More in line w/ actuals
	Student Special Programs	\$3,436	\$2,736	\$5,250	\$5,950	\$700	FLE field trips
	Travel & Conference	\$105	\$0	\$0	\$0	\$0	
Co-Curricular & Athletics Total		\$13,208	\$12,786	\$16,430	\$16,570	\$140	

Investments (4 of 8)

FncName	DESCRIPTION	Sum of FY'10 ACTUALS	Sum of FY'11 ACTUALS	Sum of FY'12 APPROVED	Sum of FY'13 PROPOSED	Sum of \$ Change	Comments
Guidance	Books	\$347	\$329	\$550	\$625	\$75	
	Dues & Fees	\$230	\$320	\$110	\$155	\$45	
	Equipment	\$0	\$0	\$0	\$0	\$0	
	General Supplies	\$1,604	\$965	\$1,815	\$1,645	(\$170)	
	Periodicals	\$0	\$0	\$230	\$230	\$0	
	Student Special Programs	\$440	\$856	\$1,000	\$1,000	\$0	
	Technology Hardware	\$67	\$135	\$200	\$200	\$0	
	Travel & Conference	\$65	\$175	\$100	\$100	\$0	
Guidance Total		\$2,753	\$2,780	\$4,005	\$3,955	(\$50)	
Health/Wellness	Books	\$69	\$0	\$0	\$50	\$50	
	Equipment	\$0	\$0	\$0	\$530	\$530	Vision chart @ SUM
	General Maintenance	\$330	\$337	\$375	\$375	\$0	
	General Supplies	\$40	\$4,704	\$5,075	\$5,525	\$450	SUM - Add'l bathroom supplies
	Other Professional Services	\$156	\$0	\$185	\$185	\$0	
	Periodicals	\$69	\$0	\$0	\$0	\$0	
	Travel & Conference	\$120	\$0	\$125	\$125	\$0	
Health/Wellness Total		\$783	\$5,040	\$5,760	\$6,790	\$1,030	
Library/Audio Visual	Audiovisual Materials	\$1,548	\$1,413	\$900	\$1,100	\$200	
	Books	\$23,140	\$23,740	\$22,475	\$23,125	\$650	
	Dues & Fees	\$35	\$35	\$35	\$35	\$0	
	Equipment	\$1,698	\$5,120	\$5,150	\$4,275	(\$875)	
	Equipment Maintenance	\$225	\$169	\$200	\$175	(\$25)	
	General Maintenance	\$0	\$414	\$375	\$675	\$300	
	General Supplies	\$8,371	\$9,025	\$9,275	\$9,064	(\$211)	
	Other Professional Services	\$100	\$0	\$0	\$0	\$0	
	Periodicals	\$4,259	\$3,987	\$3,800	\$3,565	(\$235)	
	Rentals & Leases	\$1,477	\$835	\$1,200	\$1,200	\$0	Copier lease & contract
	Student Special Programs	\$800	\$1,591	\$1,500	\$2,000	\$500	SUM - visiting author increase
	Technology Hardware	\$4,923	\$2,515	\$1,450	\$2,000	\$550	SUM iPad, FLE audio system & kindle
	Technology Software	\$4,858	\$5,075	\$6,229	\$7,045	\$816	Increased Follett costs
	Travel & Conference	\$258	\$370	\$480	\$440	(\$40)	
Library/Audio Visual Total		\$51,691	\$54,288	\$53,069	\$54,699	\$1,630	

Investments (5 of 8)

FncName	DESCRIPTION	Sum of FY'10 ACTUALS	Sum of FY'11 ACTUALS	Sum of FY'12 APPROVED	Sum of FY'13 PROPOSED	Sum of \$ Change	Comments	
District Administration	Advertising	\$4,313	\$3,109	\$7,931	\$6,841	(\$1,090)	More in line w/ actuals	
	Audit Services	\$11,491	\$9,631	\$11,200	\$11,360	\$160		
	Dues & Fees	\$1,945	\$2,220	\$2,350	\$2,350	\$0		
	Gasoline	\$2,300	\$2,300	\$2,350	\$1,563	(\$787)		
	General Supplies	\$4,238	\$7,316	\$5,000	\$4,800	(\$200)		
	Legal Services	\$15,408	\$23,329	\$13,160	\$13,162	\$2		
	Maintenance of Vehicles	\$820	\$820	\$820	\$820	\$0		
	Official/Admin Services	\$1,090	\$1,011	\$2,250	\$0	(\$2,250)		
								Custodial (\$582,982); Maintenance (\$218,566); IT (\$152,920); Security (\$16,625); netted out \$81,780 due from EHS for ESL
	Other Prof & Tech Svc	\$287,538	\$307,353	\$853,250	\$889,313	\$36,063		
	Other Professional Services	\$20,058	\$37,876	\$21,600	\$22,100	\$500	\$21.5K to Village for tax collection	
	Postage	\$0	\$661	\$500	\$600	\$100		
	Printing & Binding	\$3,865	\$3,818	\$4,931	\$4,884	(\$47)		
	Rental of Land & Buildings	\$2,600	\$2,600	\$2,600	\$2,600	\$0		
School Board Expenses	\$927	\$1,094	\$1,100	\$1,100	\$0			
SU Assessment	\$871,958	\$893,776	\$878,653	\$893,160	\$14,507	No pay freeze & less fund balance		
Travel & Conference	\$311	\$78	\$400	\$300	(\$100)			
District Administration Total		\$1,228,861	\$1,296,992	\$1,808,095	\$1,854,953	\$46,858		

Investments (6 of 8)

FncName	DESCRIPTION	Sum of FY'10 ACTUALS	Sum of FY'11 ACTUALS	Sum of FY'12 APPROVED	Sum of FY'13 PROPOSED	Sum of \$ Change	Comments
Principal Services	Audiovisual Materials	\$0	\$0	\$0	\$0	\$0	
	Books	\$1,703	\$1,192	\$1,350	\$1,220	(\$130)	
	Dues & Fees	\$2,838	\$4,330	\$3,319	\$4,444	\$1,125	Added VPA membership for HIA
	Equipment	\$3,480	\$949	\$2,550	\$4,220	\$1,670	Lobby furniture & learning kiosk at HIA (\$3.5K)
	General Maintenance	\$25	\$159	\$200	\$300	\$100	
	General Supplies	\$9,182	\$11,267	\$12,200	\$12,200	\$0	
	Miscellaneous Expense	\$3,172	\$3,568	\$2,200	\$2,200	\$0	
	Periodicals	\$45	\$60	\$79	\$89	\$10	
	Postage	\$10,425	\$9,707	\$11,320	\$10,420	(\$900)	More in line w/ actuals
	Printing & Binding	\$3,324	\$2,483	\$3,250	\$3,240	(\$10)	
	Rental of Equipment	\$712	\$712	\$500	\$500	\$0	
	Rentals & Leases	\$4,750	\$3,937	\$4,300	\$4,300	\$0	Copier lease & contract
	Student Special Programs	\$1,411	\$1,468	\$1,600	\$1,600	\$0	
	Technology Hardware	\$264	\$939	\$0	\$2,000	\$2,000	
	Testing Materials	\$1,187	\$1,500	\$1,500	\$1,500	\$0	
Travel & Conference	\$4,450	\$2,251	\$5,200	\$5,725	\$525		
Principal Services Total		\$46,967	\$44,521	\$49,568	\$53,958	\$4,390	

Investments (7 of 8)

FuncName	DESCRIPTION	Sum of FY'10 ACTUALS	Sum of FY'11 ACTUALS	Sum of FY'12 APPROVED	Sum of FY'13 PROPOSED	Sum of \$ Change	Comments
Maintenance of Plant	Building Improvements	\$96,835	\$44,215	\$38,735	\$22,625	(\$16,110)	HIA-Library shelving (\$1K); SUM-Kitchen exhaust (\$3.1K), Handicap door opener (\$2.3K); FLE-Fountains (\$2.1K), Front lighting (\$1.7K); ADL-Electrical for lab tables (\$2.3K)
	Disposal Services	\$17,175	\$14,565	\$17,050	\$17,050	\$0	
	Equipment	\$20,700	\$2,893	\$2,400	\$11,100	\$8,700	2 floor buffers, burnisher, auto scrubber batteries & 2 vacuums
	General Maintenance	\$39,529	\$50,662	\$59,895	\$47,704	(\$12,191)	Routine rqmts including plowing contract (SUM) & gym refinishing
	Land & Improvements	\$13,614	\$2,729	\$8,550	\$7,250	(\$1,300)	Landscaping; SUM sidewalk replacement
	Maintenance of Buildings	\$38,049	\$24,699	\$41,273	\$38,445	(\$2,828)	Routine rqmts + SUM exterior painting, FLE step repair & ADL whiteboard resurfacing & gas meter relocation
	Maintenance of Equipment	\$2,559	\$3,722	\$5,100	\$5,100	\$0	
	Maintenance of Grounds	\$5,616	\$1,543	\$5,115	\$9,675	\$4,560	HIA-Drainage/asphalt repair; K-5-Playground materials & reseeding
	Maintenance of Vehicles	\$183	\$230	\$800	\$800	\$0	
Maintenance of Plant Total		\$234,260	\$145,259	\$178,918	\$159,749	(\$19,169)	
Operation of Plant	Electricity	\$144,370	\$148,493	\$162,912	\$167,604	\$4,692	3 yr ave usage + 3% rate incr
	Emergency Expenses	\$7,893	\$10,501	\$10,000	\$10,000	\$0	
	Gasoline	\$700	\$700	\$700	\$700	\$0	
	General Supplies	\$45,224	\$45,947	\$44,950	\$44,950	\$0	
	Natural Gas	\$169,983	\$176,957	\$211,290	\$205,500	(\$5,790)	3 yr ave usage + 4% rate incr
	Property & Liability Insurance	\$46,868	\$47,787	\$53,725	\$52,650	(\$1,075)	Slightly lower rate
	Water/Sewage	\$12,714	\$13,804	\$14,004	\$14,910	\$906	Village upgrade = higher rates
Operation of Plant Total		\$427,753	\$444,188	\$497,581	\$496,314	(\$1,267)	

Investments (8 of 8)

FuncName	DESCRIPTION	Sum of FY'10 ACTUALS	Sum of FY'11 ACTUALS	Sum of FY'12 APPROVED	Sum of FY'13 PROPOSED	Sum of \$ Change	Comments
Safety and Security Services	Equipment	\$567	\$0	\$1,500	\$1,500	\$0	
	General Supplies	\$0	\$245	\$0	\$0	\$0	
Safety and Security Services Total		\$567	\$245	\$1,500	\$1,500	\$0	
Information Technology	Equipment	\$26,423	\$25,914	\$24,190	\$10,250	(\$13,940)	See Tech Eqmt slide
	Equipment Maintenance	\$605	\$1,558	\$5,500	\$5,500	\$0	
	General Maintenance	\$3,556	\$10,986	\$7,245	\$7,437	\$192	
	General Supplies	\$17,119	\$11,358	\$7,387	\$11,012	\$3,625	More in line w/ actuals
	Maintenance Software Support	\$5,813	\$7,071	\$8,279	\$8,401	\$122	
	Other Professional Services	\$10,342	\$19,016	\$3,500	\$3,500	\$0	
	Technology Hardware	\$53,497	\$64,963	\$52,794	\$109,250	\$56,456	See Tech Eqmt slide
	Technology Software	\$1,001	\$1,674	\$1,550	\$15,193	\$13,643	Wireless licenses (\$10.4K); VMWare licenses (\$3.3K); Reading A-Z (\$1.5K)
	Telecommunications	\$36,582	\$38,072	\$35,005	\$35,107	\$102	
	Telephone	\$74,933	\$73,933	\$74,947	\$62,887	(\$12,060)	Leased eqmt paid off mid-year
Travel & Conference	\$910	\$1,007	\$1,000	\$1,000	\$0		
Information Technology Total		\$230,781	\$255,553	\$221,397	\$269,537	\$48,140	
Student Transportation Services	Student Transportation	\$108,452	\$14,962	\$20,481	\$20,980	\$499	
Student Transportation Services Total		\$108,452	\$14,962	\$20,481	\$20,980	\$499	
Debt Service	Long Term Debt Principal	\$181,500	\$181,500	\$137,240	\$137,240	\$0	Roof bond
	Long Term Interest	\$56,435	\$46,271	\$37,030	\$28,802	(\$8,228)	Decreases each year
	Short Term Interest	\$0	\$0	\$2,500	\$2,500	\$0	
Debt Service Total		\$237,935	\$227,771	\$176,770	\$168,542	(\$8,228)	
Prior Year Adjustments	Prior Year Adjustments	(\$38,338)	(\$1,276)	\$0	\$0	\$0	
Prior Year Adjustments Total		(\$38,338)	(\$1,276)	\$0	\$0	\$0	
Grand Total		\$15,250,521	\$15,490,845	\$15,743,203	\$16,441,314	\$698,111	

Technology Equipment

	Tech Eqmt (730)	Tech HW (734)	Comments & Totals
Hiawatha			
PCs (28)		\$19,600	Replacements
Smart Boards (2)		\$5,000	Tech budget only had 1 @ \$3.5K - added a 2nd @ \$1.5K; For world language & conf rm
Laptops (2)		\$2,000	Replacements
Wireless Access Points (2)		\$1,000	Provides 100% coverage in school
Printers (12)	\$4,800		Replacements to drive down per copy cost
Projectors (2)	\$1,500		
Hiawatha Total	\$6,300	\$27,600	\$33,900
Summit			
iPads (13)		\$7,150	Teams (grade-level, MAPE, etc.) will receive training & a schedule to access the iPads with students to inform the need for future purchases and PD
Wireless Access Points (3)		\$1,500	Provides 100% coverage in school
Projector (1)	\$750		
Summit Total	\$750	\$8,650	\$9,400
Fleming			
PCs (18)		\$12,600	Replacements
iPads (12)		\$6,600	1 per classroom teacher for direct instruction on smartboards, for formative assessment, and communication; may lead to transition from minis to iPads
Smart Board (1)		\$1,500	Replacement
Clicker Set (1)		\$1,200	Classroom response system
Printers (2)	\$800		
Wireless Access Points (2)		\$1,000	Provides 100% coverage in school
Fleming Total	\$800	\$22,900	\$23,700
ADL			
Minis (92)		\$50,600	Provides one mini for each 7th & 8th grader
Laptops (1)		\$1,000	
Wireless Access Points (22)		\$11,000	Provides 100% coverage in school
Wireless Controller (1)		\$15,000	Within school vs. having data travel to EHS - increased speed
ADL Total	\$0	\$77,600	\$77,600
Miscellaneous			
Phone Equipment	\$2,400		
UPS (2)		\$2,000	
Switch (3)		\$21,000	
Servers (3)		\$10,500	
Total Miscellaneous	\$2,400	\$33,500	\$35,900
Total	\$10,250	\$170,250	\$180,500
Less Capital Plan Funds		\$61,000	\$61,000
General Fund Totals	\$10,250	\$109,250	\$119,500

Homestead Tax Rate (K-8)

Description	FY'12	FY'13	Change	% Change
Total Expense Budget	\$15,743,203	\$16,441,314	\$698,111	4.4%
- Non-Tax Revenue	\$2,822,206	\$3,250,968	\$428,762	15.2%
+ Capital Fund Contribution	\$100,000	\$100,000	\$0	0.0%
= Education Spending (ES)	\$13,020,997	\$13,290,346	\$269,349	2.1%
÷ Equalized Pupil (EP) Count	1,013.26	1,027.27	14.01	1.4%
= ES/EP	\$12,850.60	\$12,937.54	\$86.94	0.7%
÷ Base Education Amount	\$8,544.00	\$8,723.00	\$179.00	2.1%
= District Spending Adj (ES/EP / Base Ed Amt)	150.405%	148.315%	-2.090%	

Legislature sets – assumes 1 yr of inflation

Essex Junction K-8 Homestead Tax Rate	FY'12	FY'13	Change
Base Homestead Tax Rate	\$0.870	\$0.890	\$0.020
× District Spending Adj (ES/EP / Base Ed Amt)	150.405%	148.315%	-2.090%
= EJSD Estimated Equalized Homestead Rate	\$1.3085	\$1.3200	\$0.0115
÷ Common Level of Appraisal	99.76%	100.990%	1.23%
= EJSD Estimated Actual Homestead Rate	\$1.3116	\$1.3071	(\$0.005)
× % of Equalized Pupils in K-8	64.110%	65.600%	1.490%
= K-8 Estimated Actual Homestead Rate	\$0.8409	\$0.8574	\$0.0165
			\$16.53

Impact per \$100K in property

➤ Note: Tax Commissioner's recommendation was \$0.87 assuming State-wide education spending remains level with FY'12, but the Legislature will ultimately set the rate. The Base Education Amount could also be set higher. These assumptions seem to be the standard among most school districts.

Income Sensitivity Rate (K-8)

Essex Junction K-8 Income Sensitivity Rate	FY'12	FY'13	Change
Base Rate	1.80%	1.80%	0.00%
× District Spending Adj (ES/EP / Base Ed Amt)	150.405%	148.315%	-2.090%
= EJSD Income Sensitivity Rate	2.71%	2.67%	-0.04%
× % of Equalized Pupils in K-8	64.11%	65.60%	1.49%
= K-8 Income Sensitivity Rate	1.74%	1.75%	0.01%
			\$5.00

Impact for \$50K in
Income

Homestead Tax Rate (K-12)

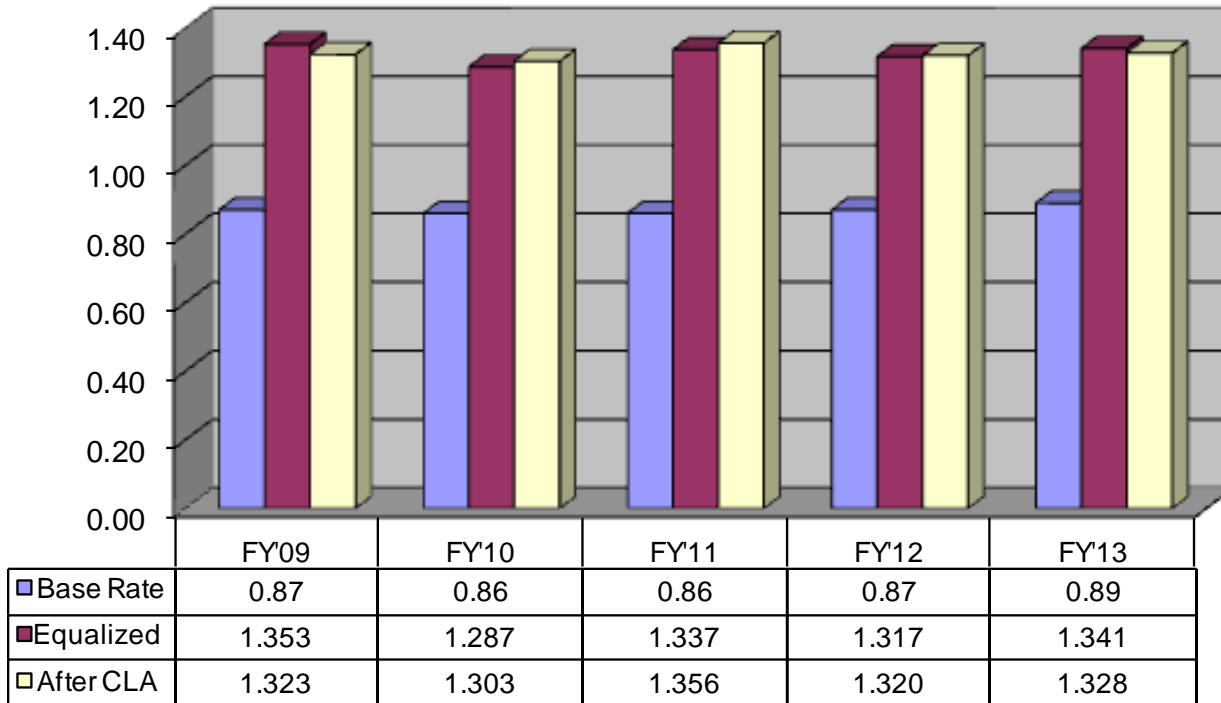

Essex Junction K-12 Homestead Tax Rate	FY'12	FY'13	Change
EJSD K-8 Rate	\$0.8409	\$0.8574	\$0.0165
+ U#46 9-12 Rate*	\$0.4789	\$0.4701	(\$0.0088)
= Estimated Actual K-12 Homestead Rate	\$1.3198	\$1.3275	\$0.0077
			\$7.73

* Gr 9-12 Equalized Homestead Rate from U#46 approved budget

Impact per \$100K in property

Income Sensitivity Tax Rate (K-12)

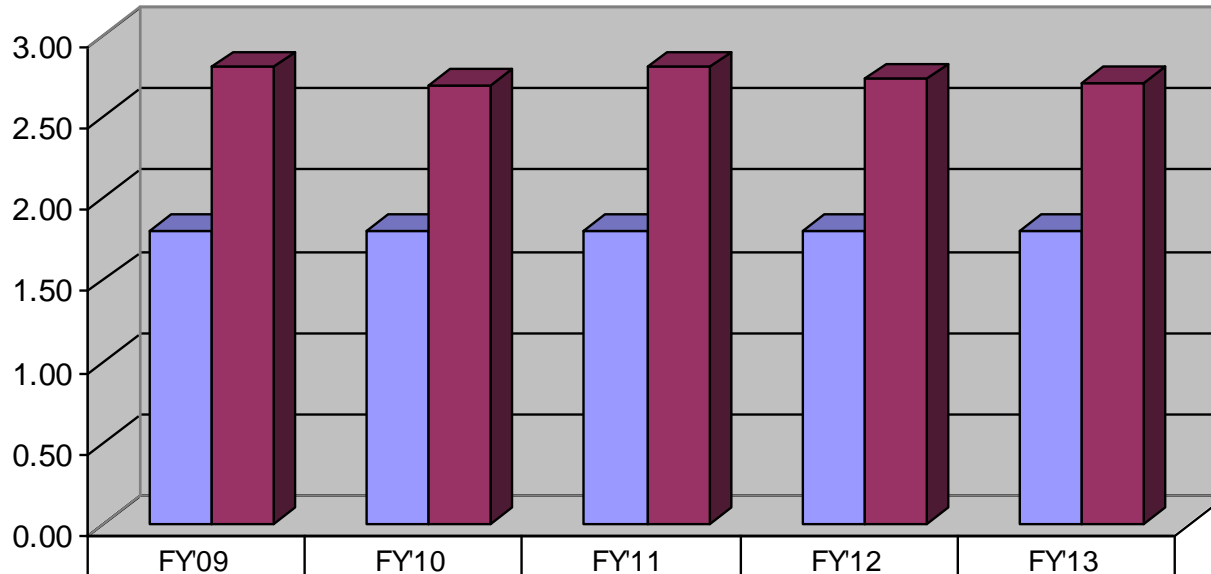

Base Rate	1.80	1.80	1.80	1.80	1.80
After spending adj	2.80	2.69	2.80	2.73	2.71

Essex Junction K-12 Income Sensitivity Rate	FY'12	FY'13	Change
EJSD K-8 Rate	1.74%	1.75%	0.01%
+ U#46 9-12 Rate*	0.99%	0.96%	-0.03%
Essex Junction K-12 Income Sensitivity Rate	2.73%	2.71%	-0.02%

* Gr 9-12 Income Sensitivity Rate from U#46 approved budget

Impact for \$50K in Income

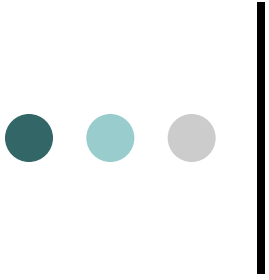

EJSD Capital Fund



EJSD Capital Plan Overview

- Funded with District's Contingency and Capital Reserve Fund
- Allowed for capital investments related to safety, accessibility, preventative & capital maintenance and environmental enhancements/ efficiencies with no tax implications
- Significant withdrawals from the Contingency and Capital Construction Fund in FY07 & 08 due to increased emphasis on capital investments
- To extend life of the fund, the Capital Plan was significantly scaled back beginning in FY09 and an article was presented/ approved to partially fund projects with \$100K in new tax revenues

EJSD Capital Plan

Title	Site	Description	FY'12	FY'13	FY'14	FY'15	FY'16
Safety & Security	DISTRICT	Security	\$6,000	\$7,000	\$7,000	\$7,000	\$8,000
		Doors	\$10,000	\$7,000	\$7,000		\$7,000
Safety & Security Total			\$16,000	\$14,000	\$14,000	\$7,000	\$15,000
Accessibility Improvement Issues	DISTRICT	Parking Lot & Sidewalk Maintenance			\$20,000	\$20,000	\$25,000
	FLEMING	Driveway & Parking Lot			\$50,000	\$42,000	
Accessibility Improvement Issues Total			\$0	\$0	\$70,000	\$62,000	\$25,000
Preventative & Routine Capital Maintenance	DISTRICT	Food Service Equipment		\$25,000		\$35,000	
		Floors (Tile/Carpeting)	\$15,000	\$15,000	\$15,000	\$15,000	\$15,000
		Roof Repairs and Maintenance		\$25,000	\$25,000	\$25,000	\$80,000
	FLEMING	Heat Plant Repairs and Maintenance	\$10,000	\$10,000	\$10,000	\$10,000	\$10,000
	FLEMING	Stage Curtain			\$25,000		
Preventative & Routine Capital Maintenance Total			\$25,000	\$75,000	\$75,000	\$85,000	\$105,000
Environment Enhancements/Efficiencies	DISTRICT	Computer Replacement Program	\$50,000	\$61,000	\$55,000	\$55,000	\$60,000
		Energy Conservation Efforts	\$20,000		\$20,000	\$20,000	\$20,000
	ADL	Replacement Lockers - Gym		\$32,000			
	HIAWATHA	Building Renovation & Vestibule	\$150,000	\$45,000			
		Remove Tennis Court		\$10,000			
Environment Enhancements/Efficiencies Total			\$220,000	\$148,000	\$75,000	\$75,000	\$80,000
Grand Total			\$261,000	\$237,000	\$234,000	\$229,000	\$225,000

Security: For replacement cameras

Doors: Replacement/Repair of exterior doors district wide - Summit

Parking Lots & Sidewalk Maintenance: No major requirements - set aside for future repairs

Fleming Loop - Driveway & Parking: One-way, clockwise loop to address traffic issues raised in independent, long-term study.

Food Service Equipment: Commercial (captive air - energy efficient) kitchen hood with fire suppression at ADL in FY'13; Replacement truck in FY'15

Floors: For repair/replacement of flooring at any EJ school - Summit re-tile (\$4.8K) and Fleming carpet (\$5.8K)

Roof Repairs & Maintenance: For maintenance of roofs at any EJ school - no pressing rqmts, will set aside for future, costly repairs

Heat Plant Repairs & Maintenance: To replace burners or pumps as needed at any EJ school - 11 boilers with 4-9 sections each

Fleming Stage Curtain: Anticipated need in near future

Computer Replacement Program: 3 Switches (\$21K); 3 Servers (\$10.5K); 29 Wireless Access Points (\$14.5K); 1 Wireless Access Controller (\$15K)

Energy Conservation Efforts: For energy conservation projects at any EJ school

ADL Lockers: Replaces lockers in both the boy's and girl's gym locker rooms

Hiawatha Renovation: Main entrance & front office suite accomplished in FY'12; Renovate itinerant staff room in FY'13.

Hiawatha Tennis Courts: Outdoor tennis courts are in disrepair and not needed - convert to green space

ADL Lockers



Hiawatha Office Renovation



Hiawatha Office Renovation

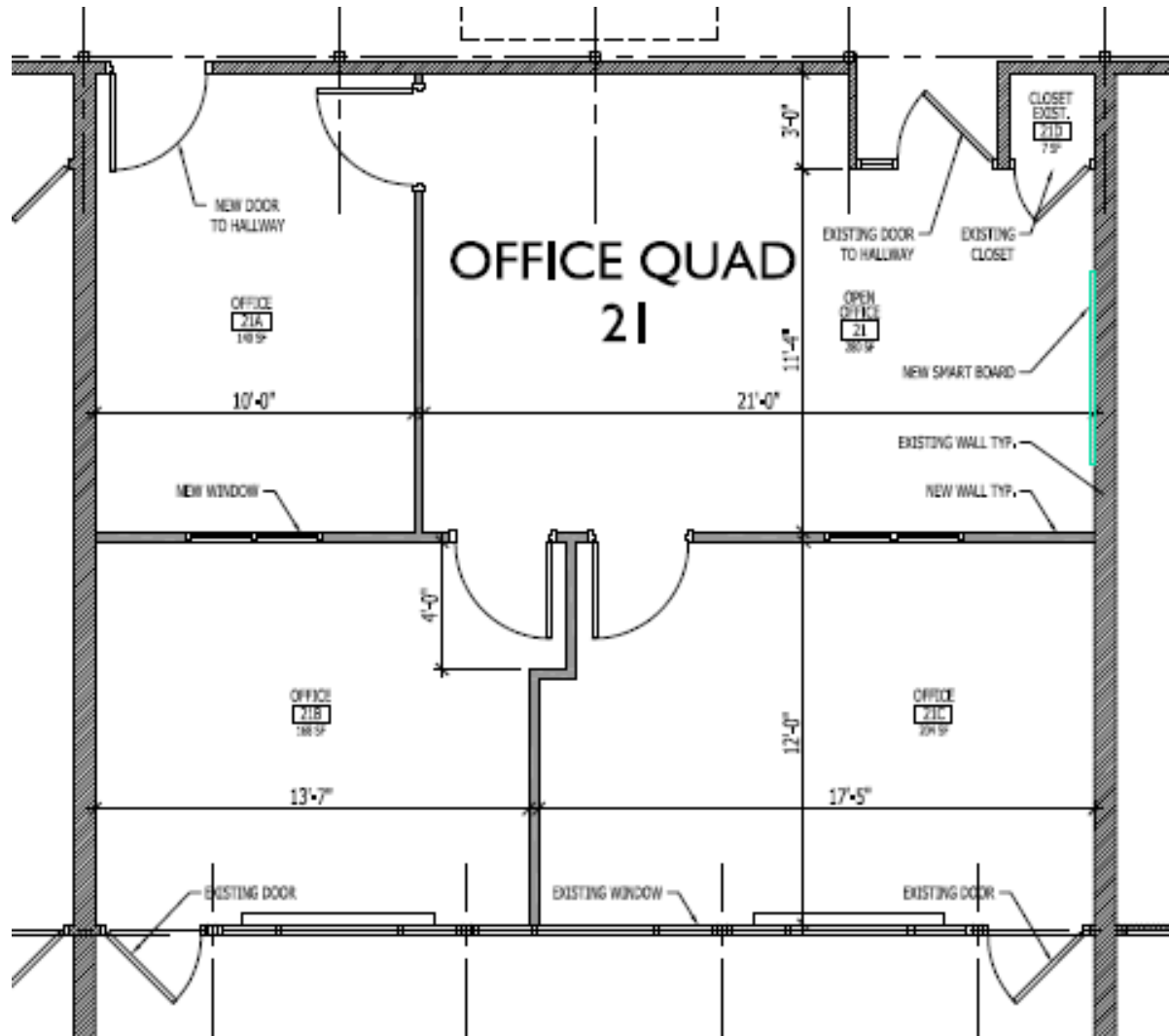

Fleming Drive & Parking Lot

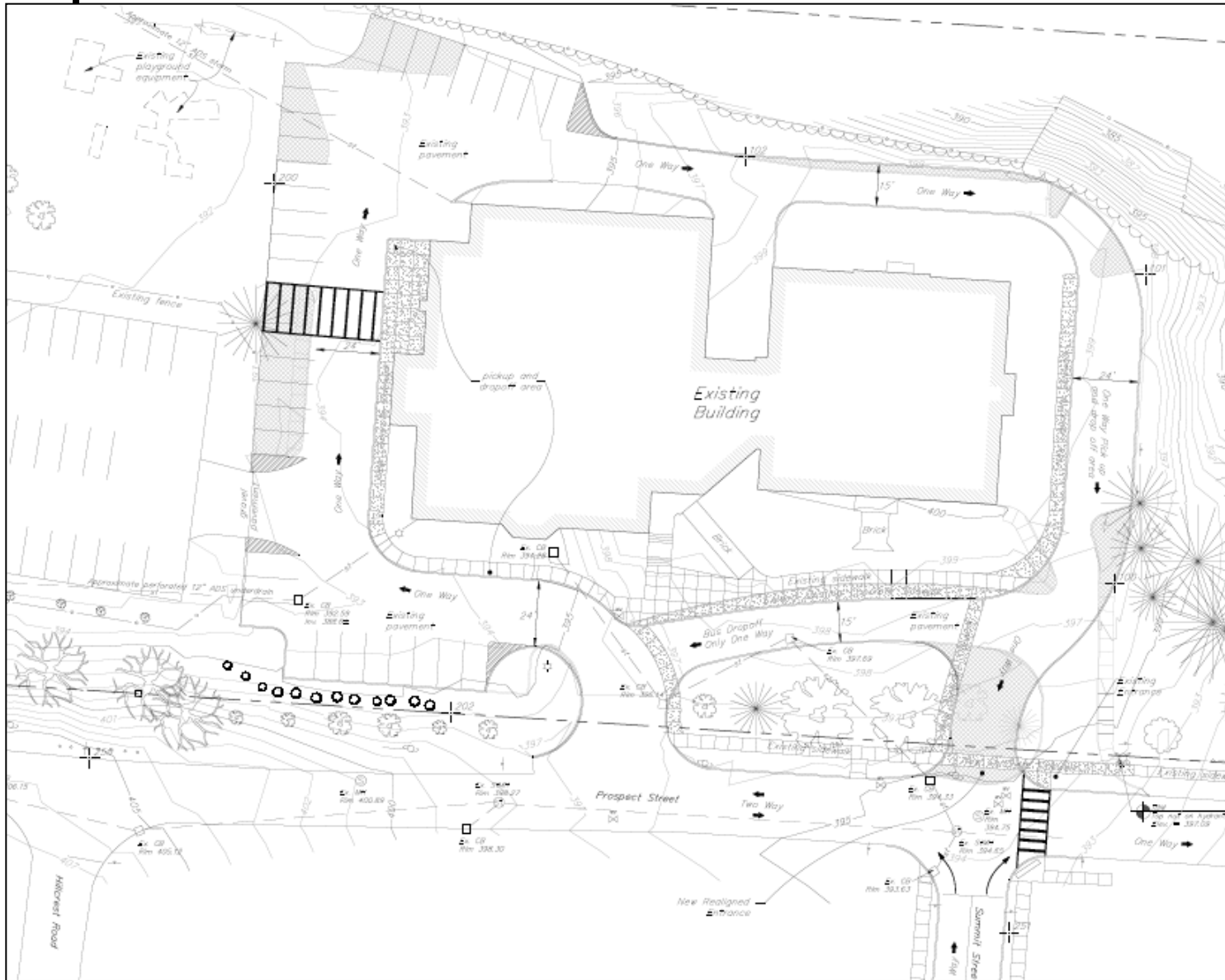



EJSD Capital Fund

Investment Status (Dec 31, 2011)

Capital Reserve Fund

\$	853,849	Certificate of Deposit (7/11/11 - 7/10/12)
\$	76,414	Cash & Equivalents
\$	237,000	Proposed FY'13 budget in Capital Plan
\$	693,263	Balance Available after FY'13 (not including Impact Fees or future interest)

- To support the current plan, taxes need to be raised for the Capital Fund starting in FY'17.
- To extend the life of the Capital Reserve and ease transition to raising Capital Funds through taxes, the Board could once again propose an article to raise \$100K in taxes to complement the Capital Reserve Funds.

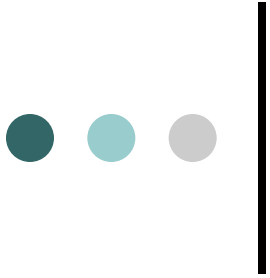

EJRP General Fund



EJRP Achievements

■ Facilities

- Cascade basketball & tennis courts were resurfaced and mini-hoops are being installed on the small court
- Trails master plan was developed for Maple Street Park
- Community volunteers spent two days preparing the future site of the Maple Street Bike Park
- Signed licensing agreement with the State which will allow for construction of a Dog Park at the West Street Complex
- West Street Community Gardens were expanded to include 40 new garden plots for the summer of 2012
- This spring the new pavilion will be enhanced with electricity & lighting; camp spaces will be completed; and a new maintenance shed will be constructed

■ Programs

- Preschool – Implemented Act 62 agreements with CCSU, CSSU, and ETSD; Moved to online student portfolios with Gold Creative Curriculum assessments; Program is full and has a waitlist
- Aspire Community Studio – Opened in January; Initial sessions of Zumba, Yoga, fitness, & dance have over 220 registered participants
- Winter Swim Lessons – Pilot program began this year with 150 children swimming at two pools in the 1st session
- Village Kids – Supports 140 children with after school care – nearly 25% of Hiawatha & Summit students participate
- Intramural Sports – Pilot program began and is showing strong support by Fleming students

■ Staff/Recreation Advisory Council (RecPAC)

- RecPAC members Wendy Johnson & Bridget Meyer were recognized by the VT Recreation & Parks Association with the annual Friends of Recreation Award
- Christina Poland (Preschool Coordinator) attended NAEYC and VAEYC conferences and is working toward a Masters in Early Childhood Education
- Harlan Smith (Head of Facilities & Grounds) attended Supervisors' Management School and renewed his certification as a Certified Playground Safety Inspector
- Mark Brislin & Ryan Hegreness (Assistant Directors) attended the National Recreation & Parks Association Congress
- Brad Luck (Director) is working toward a Masters in Public Administration at UVM

Budget (1 of 5)

Program	Description	Sum of FY'10 ACTUALS	Sum of FY'11 ACTUALS	Sum of FY'12 APPROVED	Sum of FY'13 PROPOSED	Sum of \$\$ CHANGE	Comments
Administration	Professional Staff Salaries	\$167,640	\$178,053	\$181,272	\$189,920	\$8,648	No staffing adjustments
	Support Staff Salaries	\$110,277	\$112,945	\$114,102	\$117,465	\$3,363	No staffing adjustments
	Substitute Salaries	\$0	\$0	\$500	\$0	(\$500)	
	Overtime Salaries	\$513	\$0	\$0	\$0	\$0	
	Social Security (FICA)	\$21,079	\$21,658	\$22,634	\$23,515	\$881	
	Workers Compensation	\$0	\$0	\$3,515	\$3,515	\$0	
	Health Benefits	\$64,692	\$68,907	\$74,204	\$75,859	\$1,655	VSBIT rate increase = 3.5%
	Dental Insurance Premiums	\$5,508	\$5,200	\$5,508	\$5,837	\$329	6% rate increase - 1st in 10 years
	Group Life Insurance	\$1,151	\$970	\$980	\$1,005	\$25	
	Retirement Contributions	\$11,097	\$15,985	\$17,630	\$18,390	\$760	
	Tuition Reimbursement	\$449	\$1,973	\$4,000	\$6,342	\$2,342	Inflated FY'11 actuals
	Advertising	\$4,481	\$1,997	\$3,934	\$3,059	(\$875)	
	Audit Services	\$909	\$3,169	\$2,800	\$2,840	\$40	
	Dues and Fees	\$1,761	\$1,727	\$1,651	\$1,650	(\$1)	
	Equipment	\$1,746	\$308	\$1,000	\$750	(\$250)	
	General Maintenance	\$162	\$85	\$48	\$57	\$9	
	General Supplies	\$5,064	\$4,890	\$5,000	\$4,800	(\$200)	
	Legal Services	\$1,091	\$750	\$847	\$838	(\$9)	
	Long Term Interest	\$57,474	\$52,298	\$47,022	\$35,094	(\$11,928)	Decreases each year; Refund bond
	Long Term Principal	\$105,000	\$105,000	\$105,000	\$105,000	\$0	Pool & Bldg Bond paid off in 2019
	Maintenance Software	\$122	\$59	\$62	\$62	\$0	
	Other Professional Services	\$5,875	\$2,824	\$5,100	\$6,000	\$900	
	Other Purchased Prof & Tech Services	\$25,028	\$18,325	\$13,762	\$14,693	\$931	
	Postage	\$5,999	\$4,656	\$6,356	\$6,356	\$0	
	Printing and Binding	\$11,669	\$11,274	\$11,321	\$11,716	\$395	
	Prior Year Adjustments	(\$1,822)	\$0	\$0	\$0	\$0	
	Property & Liability Insurance	\$3,962	\$4,052	\$15,451	\$15,451	\$0	
	Rental of Equipment & Vehicles	\$549	\$1,618	\$1,200	\$1,200	\$0	
	Short Term Interest	\$0	\$0	\$0	\$0	\$0	
	Supervisory Union Assessment	\$79,686	\$83,174	\$72,026	\$73,802	\$1,776	See SU Assessment slide
	Technology Hardware	\$4,475	\$2,824	\$4,410	\$4,600	\$190	
	Technology Software	\$0	\$375	\$900	\$0	(\$900)	
	Telecommunications	\$1,919	\$1,613	\$495	\$496	\$1	
	Telephone	\$10,131	\$9,557	\$8,748	\$8,359	(\$389)	Equipment lease paid off mid-year
Travel & Conference	\$8,081	\$7,367	\$8,000	\$8,000	\$0		
Fund Balance	(\$36,528)	(\$7,452)	(\$98,000)	(\$135,000)	\$37,000	See Fund Balance sheet	
Property Taxes	(\$588,749)	(\$592,629)	(\$598,554)	(\$604,857)	\$6,303	Level rate of \$0.0651 - assumes GL increase of 0.5%	
Miscellaneous Income	\$0	(\$300)	\$0	\$0	\$0		
Administration Total		\$90,493	\$123,252	\$42,924	\$6,814	\$50,496	

SU Assessment Share

	EJ Portion of SU Assess	Only Applicable to EJSD	General (Certified & Prof Staff FTE)		Central & Fiscal Service		Info Tech (# of Computers)		Assessment Totals	
			EJSD	EJRP	EJSD	EJRP	EJSD	EJRP	EJSD	EJRP
Sum of FY'13 PROPOSED		100.00%	94.01%	5.99%	80.00%	20.00%	98.42%	1.58%	92.37%	7.63%
Central Services	\$88,860				\$71,088	\$17,772			\$71,088	\$17,772
Enterprise Project	\$15,073		\$14,170	\$903					\$14,170	\$903
Executive Administrative Svcs	\$139,940		\$131,559	\$8,381					\$131,559	\$8,381
Fiscal Services	\$108,077				\$86,462	\$21,615			\$86,462	\$21,615
Food Service	\$26,406	\$26,406							\$26,406	\$0
Information Technology	\$292,508						\$287,886	\$4,622	\$287,886	\$4,622
Instr & Curr Development	\$64,770		\$60,891	\$3,879					\$60,891	\$3,879
Educational Technologist	\$37,131	\$37,131							\$37,131	\$0
Legal Services	\$36,254		\$34,083	\$2,171					\$34,083	\$2,171
Operation & Maint of Plant	\$56,817		\$53,414	\$3,403					\$53,414	\$3,403
Personnel Services	\$99,153		\$93,215	\$5,938					\$93,215	\$5,938
Special Area Admin Svces	\$55,931		\$52,581	\$3,350					\$52,581	\$3,350
Local Revenue Credit	(\$53,958)		(\$50,726)	(\$3,232)					(\$50,726)	(\$3,232)
Total	\$966,962	\$63,537	\$389,187	\$24,793	\$157,550	\$39,387	\$287,886	\$4,622	\$898,160	\$68,802
Adjustment for Treasurer Services									(\$5,000)	\$5,000
Adjusted Total									\$893,160	\$73,802

Fund Balance

FY'11 Surplus (Deficit)		\$138,548.42
+ Revenues	\$1,406,781.65	
- Expenditures	\$1,414,233.23	
+ FY'11 Fund Balance	\$146,000.00	
Recommendation (authority of electorate)		\$135,000.00
Utilize as FY'13 fund balance revenue	\$135,000.00	

Budget (2 of 5)

Program	Description	Sum of FY'10 ACTUALS	Sum of FY'11 ACTUALS	Sum of FY'12 APPROVED	Sum of FY'13 PROPOSED	Sum of \$\$ CHANGE	Comments
Parks/Pools/Facilities	Support Staff Salaries	\$93,208	\$100,501	\$109,611	\$111,590	\$1,979	
	Overtime Salaries	\$9,501	\$7,107	\$7,605	\$8,144	\$539	
	Social Security (FICA)	\$7,585	\$8,235	\$8,967	\$9,160	\$193	
	Health Benefits	(\$6)	\$0	\$0	\$0	\$0	
	Retirement Contributions	\$77	\$104	\$0	\$180	\$180	
	Dues and Fees	\$70	\$85	\$100	\$100	\$0	
	Electricity	\$26,117	\$26,772	\$24,971	\$27,734	\$2,763	3-year average usage plus 3% rate increase
	Equipment	\$6,345	\$5,136	\$7,853	\$29,637	\$21,784	Reinvesting fund balance into one-time requirements (e.g. pool house floor repair, pool fencing & grounds, etc.)
	Gasoline	\$771	\$2,021	\$1,000	\$1,439	\$439	
	General Maintenance	\$8,500	\$9,214	\$12,000	\$16,800	\$4,800	Paint & cleaning air ducts
	General Supplies	\$36,171	\$31,400	\$21,622	\$22,257	\$635	
	Land & Improvements	\$1,188	\$2,488	\$1,500	\$4,000	\$2,500	Increase to level ground along fence line
	Natural Gas	\$4,204	\$4,502	\$6,157	\$6,394	\$237	3-year average plus 4% increase
	Other Professional Services	\$4,768	\$3,492	\$5,302	\$5,520	\$218	
	Rental of Equipment & Vehicles	\$1,297	\$2,140	\$1,500	\$3,750	\$2,250	Lift to paint building
	Water/Sewage	\$2,318	\$3,062	\$4,127	\$3,935	(\$192)	
	Daily Fees	(\$42,883)	(\$49,739)	(\$38,750)	(\$44,016)	\$5,266	3-summer average
	Swim Lessons	(\$49,132)	(\$53,186)	(\$46,849)	(\$48,689)	\$1,840	Youth program fees captured here
	Pool Membership & Fees	(\$32,137)	(\$41,786)	(\$37,992)	(\$35,686)	(\$2,306)	Youth program fees were captured here
	Scholarship	(\$37)	\$0	\$0	\$0	\$0	
Field Rental	(\$4,285)	(\$5,880)	(\$4,500)	(\$5,885)	\$1,385	More in line w/ actuals	
Facility Rental	(\$3,335)	(\$2,348)	(\$1,500)	(\$2,938)	\$1,438	More in line w/ actuals	
Concession Sales	(\$19,191)	(\$22,614)	(\$18,810)	(\$20,878)	\$2,068	More in line w/ actuals	
Parks/Pools/Facilities Total		\$51,114	\$30,708	\$63,914	\$92,548	\$48,016	

Budget (3 of 5)

Program	Description	Sum of FY'10 ACTUALS	Sum of FY'11 ACTUALS	Sum of FY'12 APPROVED	Sum of FY'13 PROPOSED	Sum of \$\$ CHANGE	Comments
Youth Programs	Support Staff Salaries	\$41,853	\$41,701	\$50,504	\$49,002	(\$1,502)	More in line w/ actuals
	Overtime Salaries	\$9	\$0	\$0	\$0	\$0	
	Social Security (FICA)	\$3,191	\$3,094	\$3,863	\$3,749	(\$114)	
	Equipment	\$0	\$0	\$250	\$450	\$200	
	Field Trips	\$778	\$1,052	\$2,120	\$2,395	\$275	
	Fund Transfer Out	\$0	\$0	\$418	\$706	\$288	Skate Camp proceeds re-invested in Skate Park
	General Supplies	\$14,546	\$9,840	\$15,355	\$13,717	(\$1,638)	Decrease in summer program requirements - More in line w/ actuals
	Other Professional Services	\$15,958	\$24,119	\$10,573	\$10,738	\$165	
	Other Purchased Property Services	\$99	\$0	\$0	\$0	\$0	
	Student Special Programs	\$0	\$0	\$0	\$1,582	\$1,582	Coordinator contribution to EHS athletic student activity funds for student-athlete participation
	Scholarship	\$0	\$0	\$0	\$0	\$0	
Fees	(\$91,193)	(\$96,928)	(\$92,014)	(\$93,276)	\$1,262	Based on projected enrollment for summer camps	
Youth Programs Total		(\$14,757)	(\$17,123)	(\$8,931)	(\$10,937)	\$518	
Adult & Senior Programs	Support Staff Salaries	\$8,956	\$13,073	\$16,275	\$6,117	(\$10,158)	Aspire expenses are separate
	Overtime Salaries	\$794	\$722	\$0	\$0	\$0	
	Social Security (FICA)	\$748	\$1,030	\$1,245	\$468	(\$777)	
	Retirement Contributions	\$48	\$43	\$0	\$0	\$0	
	Equipment	\$0	\$2,434	\$2,250	\$0	(\$2,250)	No requirements
	Field Trips	\$3,413	\$3,223	\$3,405	\$3,450	\$45	
	General Supplies	\$3,219	\$7,250	\$3,380	\$3,612	\$232	
	Other Professional Services	\$6,209	\$3,763	\$4,791	\$3,667	(\$1,124)	Aspire expenses are separate
	Other Purchased Property Services	\$0	\$0	\$0	\$0	\$0	
Fees	(\$33,327)	(\$45,878)	(\$38,681)	(\$23,674)	(\$15,007)	Aspire revenues are separate	
Adult & Senior Programs Total		(\$9,940)	(\$14,339)	(\$7,335)	(\$6,360)	(\$29,039)	

➤ Youth Programs includes Summer and School Year Programs

- Summer Programs include camps for: Archery; Baseball, Basketball; BMX; Creativity; Chill; Drama; ELL; Field Hockey; Flip, Dance & Cheer; Football; Gymnastics; Mountain Bike; Rugby; Skate; Soccer; Tennis; Woodworking; & Yoga
- School Year Programs include: Basketball; Cheer; Childcare Co-op; Cooking; Gymnastics; Soccer; Tae Kwon-Do; Tumbling Tots; & Woodworking

➤ Adult & Senior Programs include: Art/Hobby; Basketball; Fall Trip; Golf; Softball; Spring Trip; Square Dancing; Summer Picnic; Tae Kwon-Do; Thanksgiving Dinner; & Volleyball

Budget (4 of 5)

Program	Description	Sum of FY'10 ACTUALS	Sum of FY'11 ACTUALS	Sum of FY'12 APPROVED	Sum of FY'13 PROPOSED	Sum of \$\$ CHANGE	Comments
Community Programs	Support Staff Salaries	\$0	\$132	\$500	\$500	\$0	
	Overtime Salaries	\$0	\$0	\$0	\$0	\$0	
	Social Security (FICA)	\$0	\$10	\$38	\$38	\$0	
	Advertising	\$600	\$1,145	\$1,242	\$842	(\$400)	
	Dues and Fees	\$1,215	\$862	\$1,485	\$1,281	(\$204)	
	Equipment	\$0	\$0	\$0	\$750	\$750	
	General Maintenance	\$0	\$126	\$200	\$200	\$0	
	General Supplies	\$4,476	\$5,627	\$6,637	\$8,316	\$1,679	Added Block Party Fun Run, Fall Pumpkin Fest, Spring Running Series
	Other Professional Services	\$14,365	\$15,475	\$16,223	\$17,490	\$1,267	Mostly for July 4th; Increase for Pumpkin Fest and our year to host Winterfest
	Other Purchased Property Services	\$0	\$161	\$0	\$0	\$0	
	Postage	\$0	\$593	\$754	\$676	(\$78)	
	Printing and Binding	\$114	\$628	\$1,620	\$1,945	\$325	
	Rental of Equipment & Vehicles	\$460	\$460	\$600	\$600	\$0	
	Water/Sewage	\$252	\$685	\$315	\$738	\$423	
	Fees	(\$9,181)	(\$12,081)	(\$10,867)	(\$14,386)	\$3,519	Increase anticipated for added Special Events (e.g. Pumpkin Fest & Block Party Fun Run) - more in line w/ actuals
Sponsorships	(\$1,950)	(\$4,250)	(\$6,898)	(\$6,648)	(\$250)		
Community Programs Total		\$10,352	\$9,573	\$11,849	\$12,342	\$7,031	

➤ Community Programs include Community Gardens and Special Events such as:

- Block Party Fun Run; Easter Egg Scavenger Hunt; Essex Has Talent; Fall Pumpkin Fest; Father's Day Fun Run; Half-Marathon; Halloween Celebration; Halloween Hustle; Holiday Bonfire; July 4th; Maple Street Park Running Series; Positive Youth Sports Alliance; Summer Family Fun Series; Winter Family Fun Gym Night; Winter Fest

Budget (5 of 5)

Program	Description	Sum of FY'10 ACTUALS	Sum of FY'11 ACTUALS	Sum of FY'12 APPROVED	Sum of FY'13 PROPOSED	Sum of \$\$ CHANGE	Comments
Licensed Childcare	Support Staff Salaries	\$225,152	\$268,879	\$309,312	\$303,080	(\$6,232)	CMS back down to 9 weeks - offsets Preschool & VK Coordinator increase
	Substitute Salaries	\$0	\$0	\$0	\$0	\$0	
	Overtime Salaries	\$5,814	\$0	\$0	\$0	\$0	
	Social Security (FICA)	\$17,086	\$20,216	\$23,663	\$23,186	(\$477)	
	Health Benefits	(\$401)	\$10,263	\$11,513	\$31,831	\$20,318	Benefits for VK Coordinators
	Dental Insurance Premiums	\$0	\$875	\$875	\$2,919	\$2,044	Benefits for VK Coordinators
	Group Life Insurance	(\$3)	\$78	\$78	\$153	\$75	
	Retirement Contributions	\$276	\$0	\$2,575	\$2,726	\$151	
	Construction Services	\$51,709	\$0	\$0	\$0	\$0	
	Equipment	\$7,517	\$2,020	\$3,600	\$2,900	(\$700)	
	Field Trips	\$8,539	\$12,563	\$20,260	\$23,105	\$2,845	Added field trips for VK vacation camps
	General Supplies	\$23,593	\$25,102	\$28,314	\$27,308	(\$1,006)	More in line w/ actuals
	Other Professional Services	\$1,225	\$5,982	\$10,240	\$9,310	(\$930)	More in line w/ actuals
	Travel & Conference	\$463	\$1,115	\$2,700	\$2,700	\$0	
Fees	(\$468,231)	(\$479,163)	(\$515,551)	(\$523,625)	\$8,074	Preschool & VK up - based on enrollments; CMS down (10 to 9 weeks)	
Licensed Childcare Total		(\$127,261)	(\$132,071)	(\$102,421)	(\$94,407)	\$24,162	
Total Investments		\$1,380,159	\$1,413,933	\$1,508,966	\$1,559,558	\$50,592	
Total Revenues		(\$1,380,159)	(\$1,413,933)	(\$1,508,966)	(\$1,559,558)	\$50,592	

➤ Licensed Childcare includes: Preschool, Village Kids, and Camp Maple Street

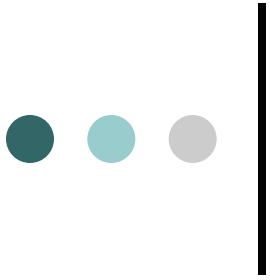

EJRP Capital Fund



EJRP Capital Fund

Title	Description	FY'12	FY'13	FY'14	FY'15	FY'16
Life Safety & Security	Playground Equipment			\$10,000		
	Resurfacing	\$24,000	\$10,000	\$6,500		\$3,000
Life Safety & Security Total		\$24,000	\$10,000	\$16,500	\$0	\$3,000
Preventative & Routine Maintenance	Fencing				\$15,000	\$45,000
	Parking Lot			\$4,000		
	Maintenance Equipment		\$21,000	\$12,000	\$22,000	
Preventative & Routine Capital Maintenance Total		\$0	\$21,000	\$16,000	\$37,000	\$45,000
Environment Enhancements	Park Amenities	\$30,000	\$18,000	\$11,500	\$32,500	\$5,500
	Pedestrian Paths	\$15,500	\$20,500	\$25,500		\$16,000
	Landscaping	\$5,500	\$5,500	\$5,500	\$5,500	\$5,500
Environment Enhancements Total		\$51,000	\$44,000	\$42,500	\$38,000	\$27,000
Grand Total		\$75,000	\$75,000	\$75,000	\$75,000	\$75,000

Playground Equipment: FY'14 - Maple St requirements

Resurfacing: FY'13 - Maple St basketball/skatepark/playground; FY'14 - Maple St tennis courts

Fencing: FY'15 - B Field backstop & baseline; FY'16 - Seman Field backstop & baseline, Cascade tennis court, backstop & baseline

Parking Lot: FY'14 - Cascade re-coat

Maintenance Equipment: FY'13 - park utility vehicle & zero turn mower for Cascade; FY'14 - replacement truck; FY'15 - mower

Park Amenities: FY'13 - Cascade shed, pool equipment; FY'14 - Concessions & Pool equipment; FY'15 - Pool house bathrooms, Pool water feature, Pool equipment, Cascade - general improvements & replacement equipment (\$4.5K)

Pedestrian Paths: FY'13 - Repair of existing paths & creation of new paths at Maple St; FY'14 - Cascade path extended & continue Maple St paths; FY'16 - Maple St paths continued

Landscaping: Continued development of landscape plan and implementation at Maple St



Summary

■ EJSJ General Fund

- Total budget = **\$16,441,314**
- Education Spending shows an **increase** of \$269,349 or **2.1%**, but lower than FY'11
- Includes larger than usual budget-to-budget salary increases

■ EJSJ Capital Plan

- Total budget = **\$237,000** – reflects a **decrease** of \$24,000 or **-9.2%**

■ EJRP General Fund

- Total budget = **\$1,559,558**
- Represents an **increase** of \$50,592 or **3.4%**
- Constrained by **level tax rate** (\$0.0651)
- About 60% of the budget is funded by program revenues

■ EJRP Capital Plan

- Total budget = **\$75,000** – held at current level



EJSD Budget – The Road Ahead

Feb 2 – Budget Work Session

Feb 9 – Budget Work Session

Feb 16 – Budget Work Session (if needed)

Mar 19 – Board Meeting (budget presentation)

Apr 9 – Informational Hearing

Apr 10 – Budget Vote

Informational Hearing

Monday, April 9, 2012
6:30 p.m.

- Essex High School
Cafeteria

Don't Forget to Vote

Tuesday, April 10, 2012

7:00 a.m. – 7:00 p.m.

- Essex High School
(Village Residents)

- Essex Middle School
(Town Residents)

