

EJSD FY'13 Budget

2nd Draft – February 2, 2012

Contents:

- EJSD General & Capital Plan
- EJRP General & Capital Plan



Board Guidance

EJSD General Fund

Maintain the high level of educational quality presently found in the District

Support the essential elements of the School Action Plan analyzing current practices as well as unfunded requirements and adjusting as necessary for enrollment

Be sensitive to the burden on tax payers by presenting a proposed budget with a minimal increase to education spending

EJSD Capital Fund

Propose continued, responsible reductions. Make recommendations relating to the depletion of the Capital Reserve Fund and how it will impact the taxpayer

EJRP General Fund

Level Tax Rate – Propose a balanced budget with the Property Tax revenue being calculated off the current municipal tax rate.

EJRP Capital Fund

Propose a Capital Plan constrained by \$75,000 per year.



At A Glance

■ EJSJ General Fund

- Total budget = **\$16,441,314**
- Education Spending shows an **increase** of \$269,349 or **2.1%**, but is lower than FY'11
- Includes larger than usual budget-to-budget salary increases

■ EJSJ Capital Plan

- Total budget = **\$237,000** – reflects a **decrease** of \$24,000 or **-9.2%**

■ EJRP General Fund

- Total budget = **\$1,559,558**
- Represents an **increase** of \$50,592 or **3.4%**
- Constrained by **level tax rate** (\$0.0651)
- About 60% of the budget is funded by program revenues

■ EJRP Capital Plan

- Total budget = **\$75,000** – held at current level

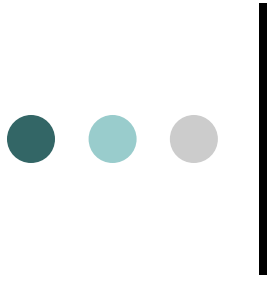

EJSD General Fund



Summit Achievements

■ School

- Celebrating its 60th year educating Essex Junction's children!
- Utilizing videoconferencing and Virtual Field Trips for activities such as viewing animals at the Bronx Zoo to learn about animal adaptation, viewing "Polar Bears International" from Manitoba, Canada, visiting a station to learn about Weather Science, etc. Children ask questions and learn first-hand from scientist working in the field.
- Standards-based teaching and learning is evidenced by revised report cards aligned with the CCSU Power Standards to ensure consistency between grade level classes for K-5 students and their parents.
- Natural Playground Committee secured funds to pay for the design of a playground for the school and community at large. Steps are in progress to make this design a reality in the upcoming years.

■ Students

- After introducing the Six Pillars of Character as a means to reinforce positive behaviors, hundreds of students have been recognized at school assemblies as Stars of the Week for displaying positive characteristics such as: Trustworthiness, Respect, Responsibility, Fairness, Caring, Citizenship.
- 57% of last year's third graders were awarded the highest level of Achievement with Distinction on the Mathematic NECAP assessment.
- Students in several classrooms were involved in a special project to publish a book and digital stories entitled: Playgrounds Around the World; this was a culmination of connections made via Skype and video conferencing with schools in Hawaii, Honduras, Alaska, and Kentucky, just to name a few.

■ Staff

- Regina Sewell (Special Educator) was asked to serve on the VT Response to Intervention (RTI) Steering Committee charged by the DOE to develop policy level guidelines for what RTI should look like in Vermont.
- Meghan Turcot (2nd Grade Teacher) and Katherine Duggan (Learning Center Director) created Blogs to communicate with parents and children.
- Under the leadership of Jade Hazard (math educator), the Dynamic Indicators of Basis Early Literacy Skills (DIBELS) Math Universal Screening is being piloted by K-3 educators as a data point to inform instruction and programming.



Hiawatha Achievements

■ School

- Began the school year with a new main entrance, lobby, and main office suite – positive feedback from everyone
- The prekindergarten program was recognized in September 2011 as a four-star program as measured by criteria established by the State's Department of Children & Families
- Nearly every learning place within the schoolhouse now employs a SmartBoard as a means of integrating technology with instruction

■ Students

- The percentage of socio-economically disadvantaged children meeting NECAP reading & math standards has almost doubled since 2006
- Nearly 80% of students participated in fundraising efforts for a local food shelf and for the Hurricane Irene Relief Fund
- Two artist in residence projects are nearing completion in support of the fine art's curriculum including a mural project utilizing recycled materials and a dance project celebrating diversity
- Third grade students participated in the 1st school-wide community service work project – volunteering break time to perform community service within the schoolhouse

■ Staff

- Mary Beth Funtow was recognized as the CCSU Elementary Teacher of the Year – sponsored by the UVM Teacher Recognition Program
- Tom Bochanski was recognized as Vermont's 2011 National Distinguished Principal – sponsored by the National Association of Elementary School Principals



Fleming Achievements

■ School

- Celebrating the 100th year of learning in our wonderful facility - events planned for the week of June 1-9
- Successfully implemented new Vertical House Teams to enhance collaborative teaching & learning opportunities
- Offering an intramural program option on Tuesdays & Thursdays after school in response to healthy schools assets survey results.

■ Students

- Conducted fund raisers and a book drive to provide Hurricane Irene flood relief to four communities and also sent banners & cards
- Over 40 students are participating in the Math Olympiad Program after school
- 60% of students are participating in the school instrumental music program
- The Fleming Spelling Team participated and achieved competitive success in the VPA Regional Spelling Bee. This fifth grade team competed against 5th/6th grade middle school teams in the region .
- The Fleming School Geography Bee Champions have qualified for the Vermont State National Geographic Geo Bee every year since 2001
- The Fleming Dance Team champions performed at UVM as a fundraiser for the University's athletic programs

■ Staff

- Teachers participated in Responsive Classroom consultation & coaching sessions with a focus on Academic Choice
- Teachers have dedicated meeting and coaching time to work with a literacy consultant to further their knowledge and use of the Fountas & Pinnell assessment program
- Teachers are continuing grade level work with a math consultant to model new instruction & assessment techniques
- Teachers have continued their work with formative assessment in the area of writing quality constructive responses. This cross-curriculum, thinking through writing, schoolwide focus has resulted in improvement and steady growth.



ADL Achievements

■ School

- Continued focus on co-teaching in language arts & math, differentiated instruction, standards-based planning, assessing & reporting, and curriculum mapping
- Continued focus on technology integration, next generation skills, and a vision for technology use & information literacy for students and educators
- Proud of our many after school events such as: Holiday Concert, Annual Diversity Day, Annual Empty Bowls Night, Annual Basketball Tourney (#42 this year!), Annual Musical, etc. – always well-attended and provide important life lessons

■ Students

- Nate Baliff and Hannah Couture were recognized by the NE League of Middle Schools & VT Association of Middle Level Educators as ADL's Middle Level Scholar Leaders
- Kirk Teare won 1st place in the Annual Peace Poster contest sponsored by the Lion's Club
- Each student shared in the responsibility of creating a school-wide social contract – posted in the cafeteria
- ADL's chorus, band and orchestra programs comprise more than 2/3rds of the student body
- Significantly raised our 8th grade science NECAP scores over the last two years; well above the state average

■ Staff

- Teachers worked with a Differentiated Instruction consultant to review professional development needs
- Participating in monthly co-teaching professional development
- 17 educators participated in a Developmental Design class (similar to Responsive Classroom, but for middle school)
- Teachers are working with colleagues from Essex High School to utilize an IBM grant and mentorship to plan for implementation of Science, Technology, Engineering, & Math (STEM) and STEAM (integrating the Arts) at ADL
- Amanda Eldridge was a recipient of the Positive Youth Sports Alliance Coach of the Year
- Laurie Singer was the recipient of the National Association of Secondary School Principals and John Winton Middle Level Educator of the Year Award for VT



FY'13 Considerations

- Year following large reductions for ‘Challenges for Change’
- FY'12 budget assumed ‘steps-only’ settlement
- FY'11 fund balance - \$948K

FY'13 Fund
Balance
Revenue
(\$750K)

- Level revenue requires \$600K
 - Budget-to-budget salary increase (assumption vs settlement) - \$150K
 - Article to commit \$198K for lower than anticipated future revenues to add to the existing \$190K
- **Use of Education Jobs Fund - \$79.5K**
 - Third and final year
 - Continue to use to offset private preschool agreements
 - In FY'14, revenue goes away, but full tax rate benefit is gained (able to count all equalized pupils)

Educational Quality – Multi-year

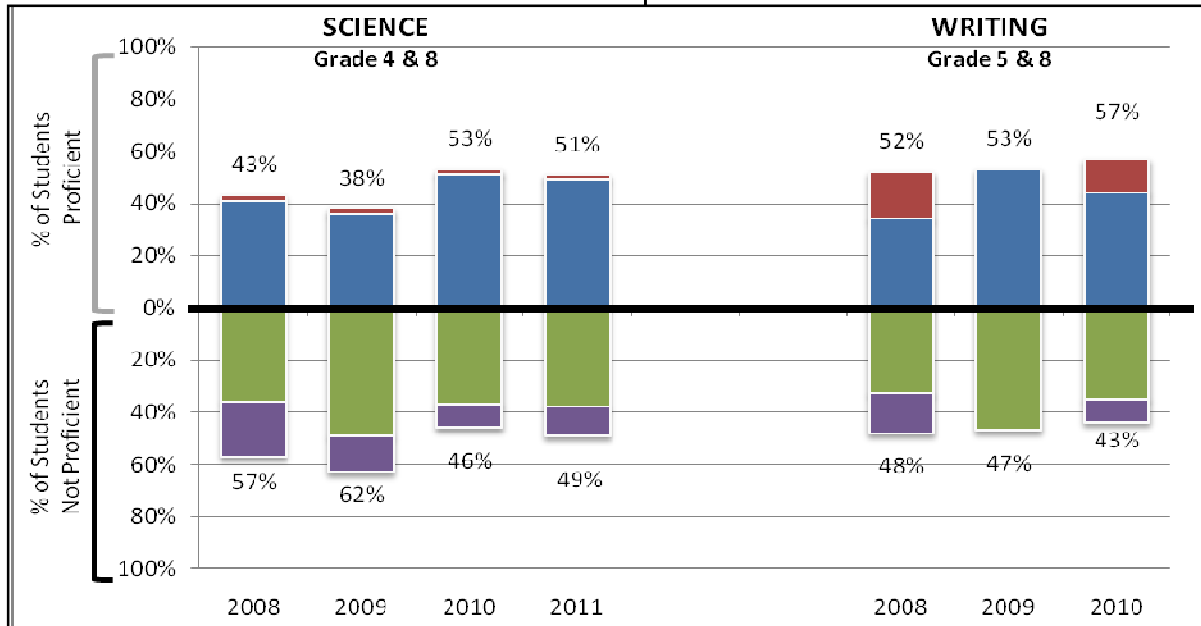
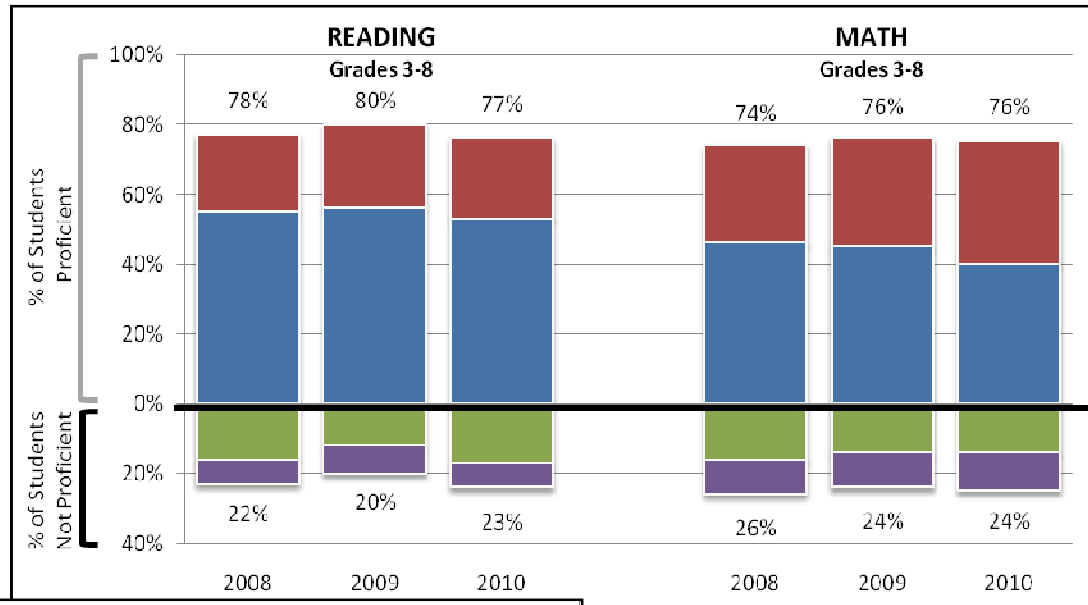

- Proficient with distinction
- Proficient
- Partially proficient
- Substantially below proficient

Educational Quality – Comparison

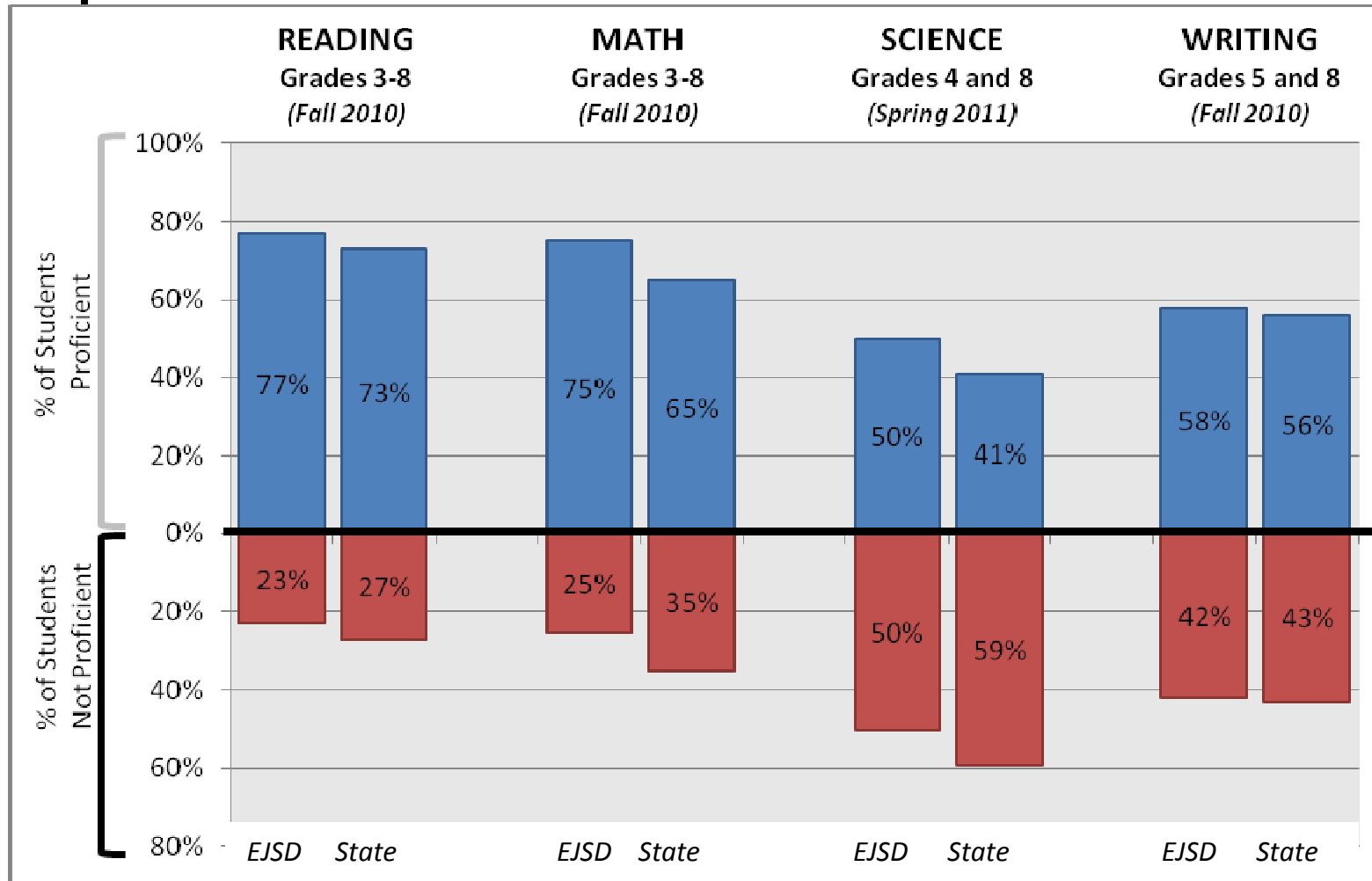

EJSD Enrollment Projections



Enrollment Projection

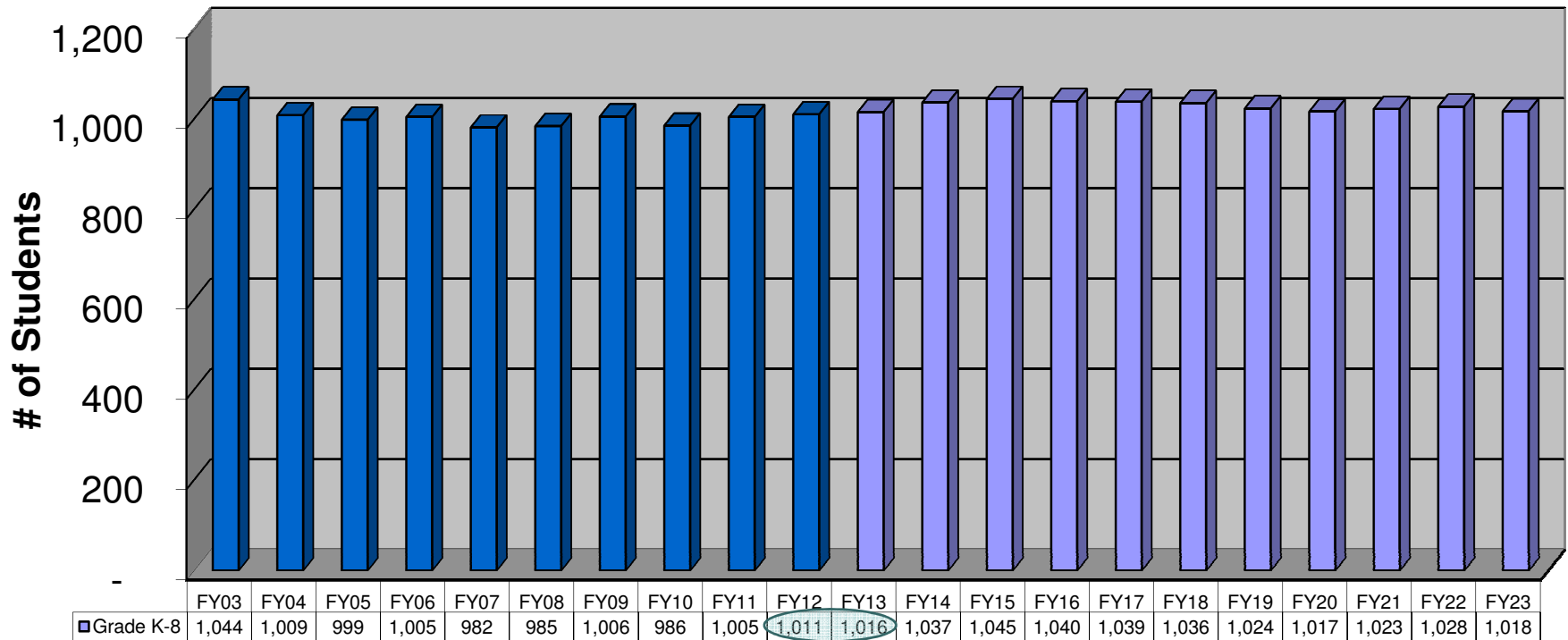

- FY'12 projection was 1,011 and the Oct 1 count was 1,011 (0.0% variance)
- Projection shows an increase in the next few years which ends up leveling off around 1,025 over the next decade

Budget Overview

Description	FY'11	FY'12	FY'13	Change	% Change
Total Expense Budget	\$16,004,189	\$15,743,203	\$16,441,314	\$698,111	4.4%
- Non-Tax Revenue	\$2,787,141	\$2,822,206	\$3,250,968	\$428,762	15.2%
+ Capital Fund Contribution	\$100,000	\$100,000	\$100,000	\$0	0.0%
= Education Spending (ES)	\$13,317,048	\$13,020,997	\$13,290,346	\$269,349	2.1%
÷ Equalized Pupil (EP) Count	998.75	1,013.26	1,027.27	14.01	1.4%
= ES/EP	\$13,333.72	\$12,850.60	\$12,937.54	\$86.94	0.7%
÷ Base Education Amount	\$8,544.00	\$8,544.00	\$8,723.00	\$179.00	2.1%
= District Spending Adj (ES/EP / Base Ed Amt)	156.059%	150.405%	148.315%	-2.090%	

Ed Spending lower than FY'11

Ballot article amount

Assumption - requires Legislative action

Slight increase in Education Spending

Key factor in tax rate calculation

Act 82 – Two Vote Requirement

The answer to both questions must be "YES" to require 2nd vote	
1. Did prior year ES/EP exceed the prior year state average?	YES
FY'12	
Education Spending Per Equalized Pupil (ES/EP)	\$ 12,850.60
State-wide average	\$ 12,287.46
2. Does the proposed ES exceed the MIA?	NO
FY'13	
Proposed Budget	
Expense Budget	\$ 16,441,314
- "Local" Revenues	\$ 3,250,968
+ Capital Fund Contribution	\$ 100,000
= Education Spending	\$ 13,290,346
Maximum Inflation Amount	
Essex Junction SD prior year ES/EP	\$ 12,850.60
+ Inflation index (3.1% * FY'12 state average)	\$ 380.91
= MIA per EP	\$ 13,231.51
* Equalized Pupils (can use current or prior)	1,027.27
= District's Maximum Inflation Amount	\$ 13,592,333
Is a 2nd vote be required?	NO

Excess Spending Threshold

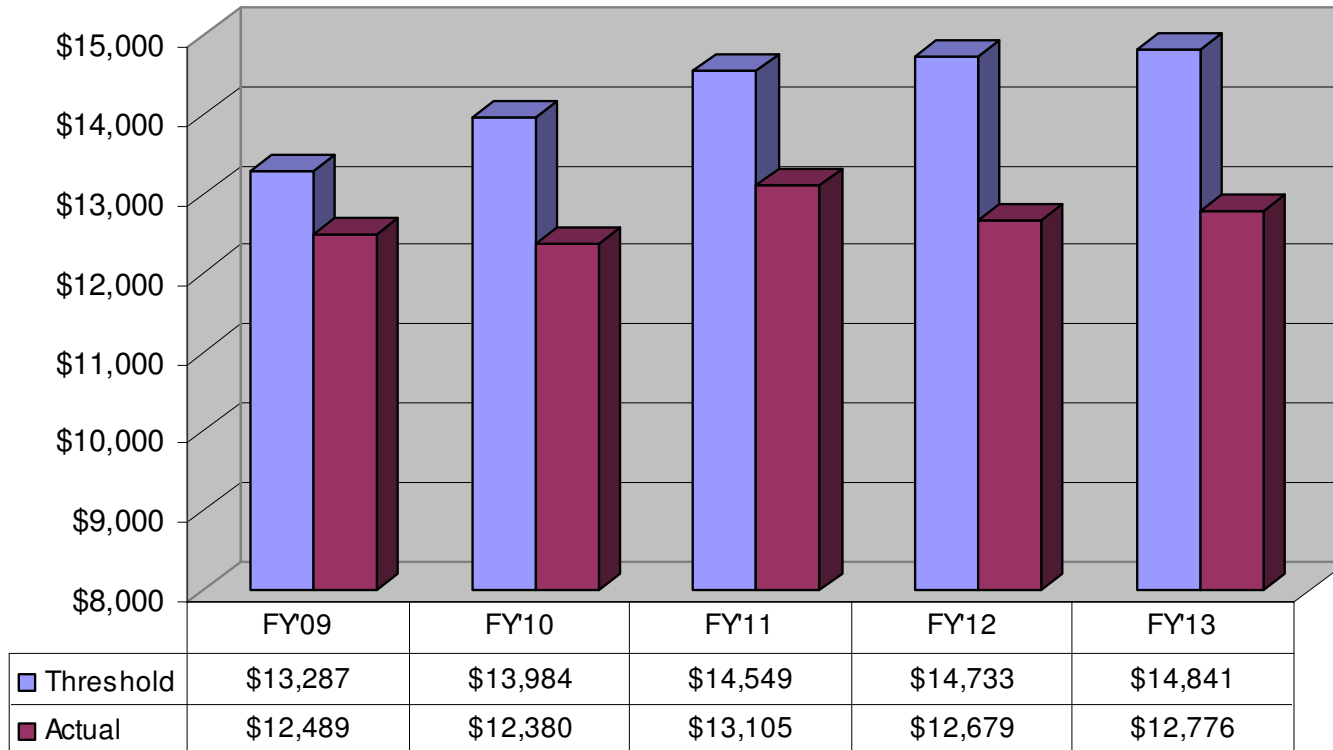

The “Actual” amount differs from Education Spending per Equalized Pupil because eligible construction costs are backed out.

Overview – Revenues (\$16.4M)

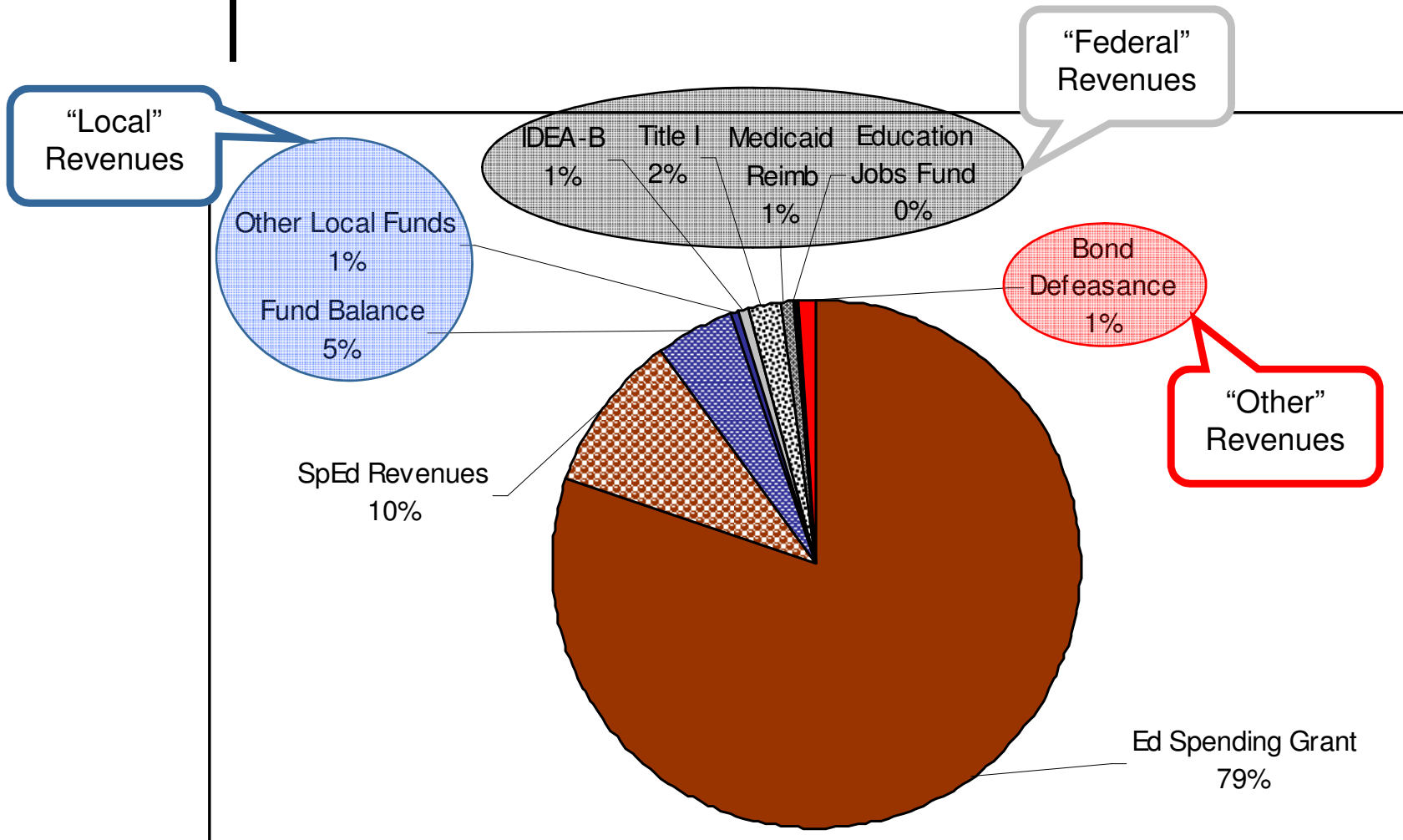

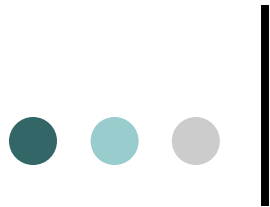

Significant Budget Changes

Revenues:

	<u>FY'12</u>	<u>FY'13</u>	<u>Change</u>
Fund Balance	\$600,000	\$750,000	\$150,000

➤ FY'11 available fund balance of \$948K is higher than the prior year. An increase in fund balance this year could be followed by a decrease (and tax rate increase) for FY'14.

- \$750K is proposed as FY'13 revenue. The increase of \$150K is reasonable since there are some 'one-time' budget increases (higher than usual budget-to-budget increase due to difference in assumptions versus actual settlement).
- The remaining \$198K will be shown as a special article for use in a future year when revenues are lower than anticipated.

	<u>FY'12</u>	<u>FY'13</u>	<u>Change</u>
Local Tuition	\$0	\$12,500	\$12,500

➤ Anticipate one tuitioned student at ADL.

	<u>FY'12</u>	<u>FY'13</u>	<u>Change</u>
Education Spending Grant	\$12,920,997	\$13,190,346	\$269,349

➤ Balances revenues with investments – minimal tax impact.



Significant Budget Changes

	<u>FY'12</u>	<u>FY'13</u>	<u>Change</u>
Special Education Reimbursement	\$1,452,675	\$1,622,753	\$170,078

➤ Anticipated increase in student needs (and associated costs) result in a higher level of SpEd revenues from the State.

	<u>FY'12</u>	<u>FY'13</u>	<u>Change</u>
Federal Title I Grant	\$209,409	\$307,804	\$98,395

➤ Amount needed to fund current staffing levels for Math specialists & tutors. In line with the amount actually awarded in FY'12. However, the amount of federal grants is always an unknown.

Total Increase of \$698,111

Overview – Investments (\$16.4M)

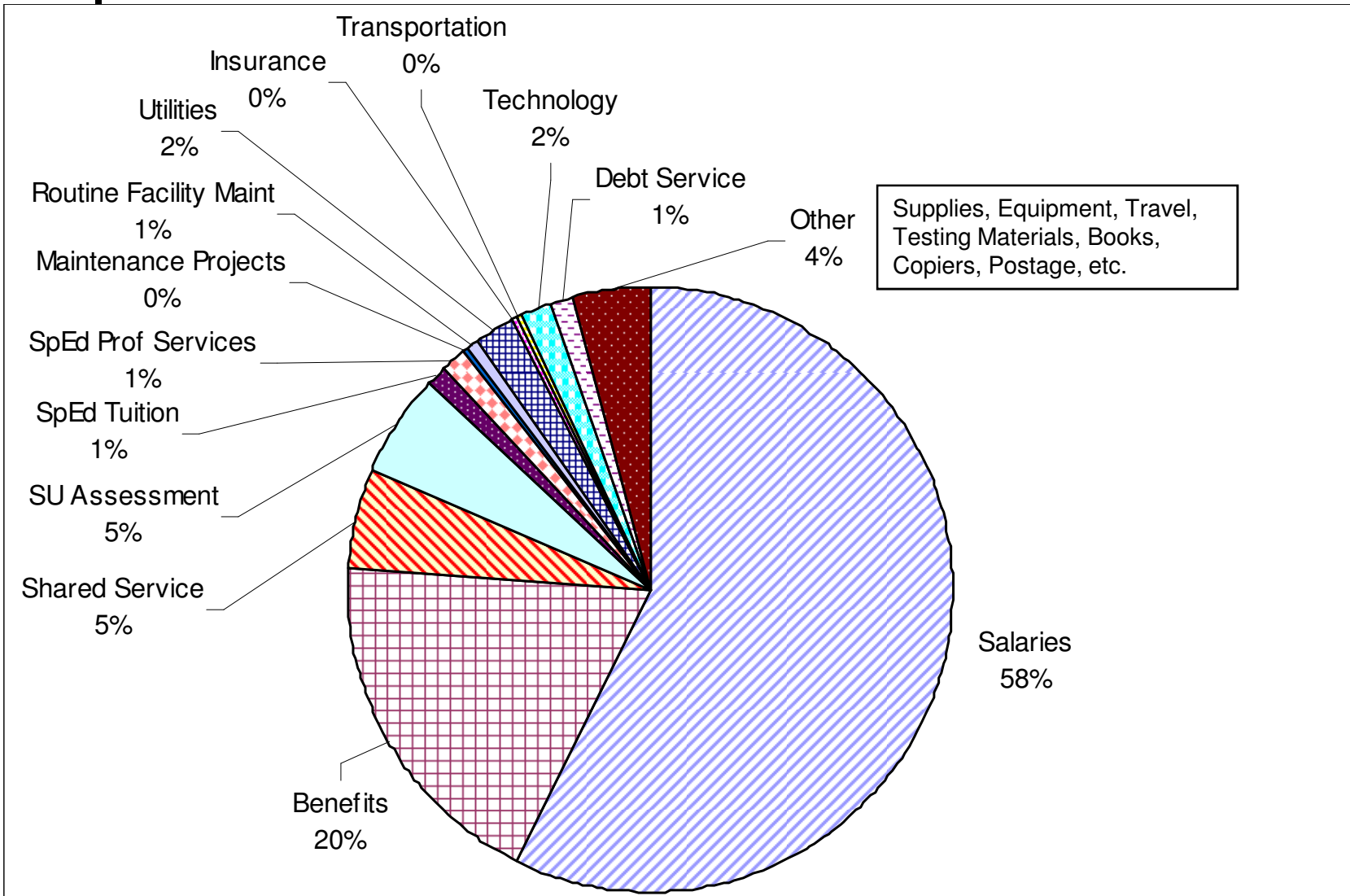

Budget Overview

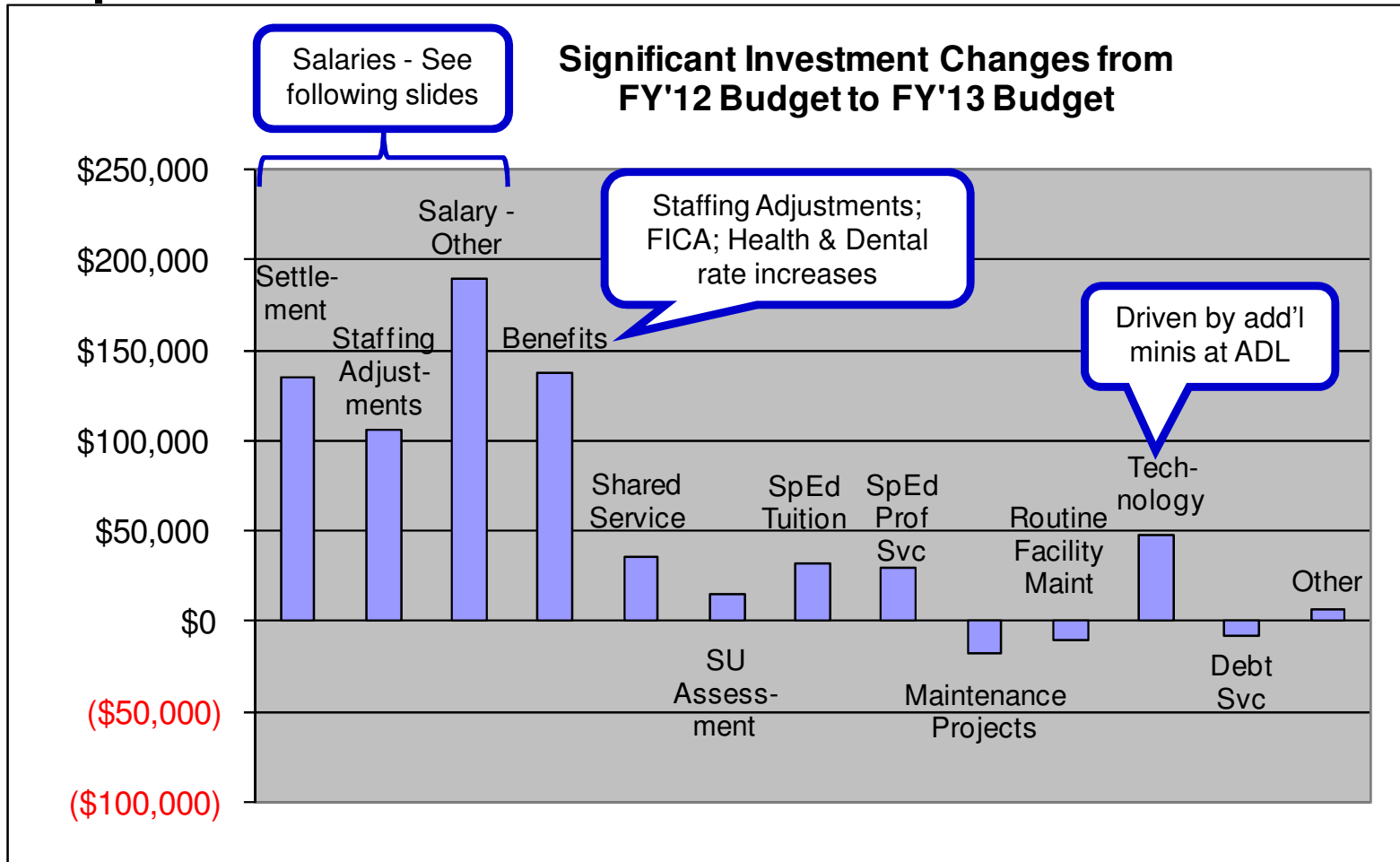



Significant Budget Changes

Investments:

	<u>FY'12</u>	<u>FY'13</u>	<u>Change</u>
Salaries & Benefits	\$11,929,164	\$12,496,098	\$566,934
Salaries	\$8,961,908	\$9,391,098	\$429,190
Benefits	\$2,967,256	\$3,105,000	\$137,744

➤ Salaries:

- Settlement (\$134K) – The FY'12 salary line assumed a 'steps-only' settlement, but the actual agreement provided teachers with a 2.7% increase – meaning the FY'12 budget is low and the budget-to-budget increase is higher than normal.

- Staffing Adjustments (\$106K) – Sustain FY'12 level of increased Title I math support; Additional Special Education Interventionist based on student need; 1.5 Teacher Assistant FTE; ADL Assistant Principal/Athletic Director adjustments – minor savings.

- Other Salary Changes (\$189K) – Since Salary costs make up over 50% of the budget, even inflationary pay raises cause significant budget increases. Additionally, the early departure incentive (\$43K) is included in this line – five employees opted for the incentive in FY'12, while six opted for the incentive in FY'13.

➤ Benefits:

- Social Security (\$33K) – Increase in line with salary increase.

- Health (\$90K) – Fortunate that health premiums only increased 3.5%.

- Dental (\$17K) – Self-insured dental plan raised rates for the 1st time in 10-year history



Staffing Adjustments

Budget Adjustment	Position Description	FTE Adj	\$ Adj
FY'12: Increased Title I Funding	MATH SUPPORT SPECIALIST	0.50	\$30,145
	TITLE I MATH TUTOR	2.00	\$58,891
FY'13: Projected Student IEP Need	INTERVENTIONIST	1.00	\$38,015
FY'13: New - TA Support (w/ EJRP)	MAINSTREAM TA	1.50	\$47,682
FY'13: Athletic Director	ASSISTANT PRINCIPAL	-0.08	(\$8,380)
	ATHLETIC DIRECTOR	1.00	\$2,936
Total Adjustment		5.92	\$169,289

■ Title I Math Support

- The positions noted above were added in FY'12 as a result of receiving more Title I funds than anticipated and the proposed budget maintains the same staffing level
- Total Title I math support proposed is 2.5 specialists and 3 tutors
- If less than anticipated funding is received in FY'13, all positions can be covered by General Funds or tutor positions can be eliminated

■ Interventionist

- Requirement driven by student need

■ TA Support (w/ EJRP)

- 3 full-time positions are being proposed with funding split between EJSD and EJRP
- EJSD funds would be used to fund 3 part-time positions at Hiawatha, Summit, and Fleming to act as regular education TAs to provide coverage for lunch, recess, etc.

■ ADL Athletic Director (AD)

- Removes AD responsibilities from Assistant Principal (AP) position – AP is reduced from a full-year position to an extended school-year position and AD becomes a stipend position



Significant Budget Changes

	<u>FY'12</u>	<u>FY'13</u>	<u>Change</u>
Special Education Tuition & Services	\$363,263	\$425,766	\$62,503

➤ Anticipated increase in outside placements (\$33K) and increased psychological services (\$30K) as a result of an increased number of triennial reviews. Offset by additional Special Education reimbursement.

	<u>FY'12</u>	<u>FY'13</u>	<u>Change</u>
Shared Service	\$853,250	\$889,313	\$36,063

➤ Reimbursement to the U#46 School District for custodial, maintenance, information technology, and security services based on factors such as FTE, square footage, number of computers.

	<u>FY'12</u>	<u>FY'13</u>	<u>Change</u>
SU Assessment	\$878,653	\$893,160	\$14,507

➤ Minor increase because there is no longer an administrator pay freeze and the SU fund balance decreased.

	<u>FY'12</u>	<u>FY'13</u>	<u>Change</u>
Building Improvements	\$38,735	\$22,625	(\$16,110)

➤ Less improvements needed – significant investment in facilities over the past several years.



Significant Budget Changes

	<u>FY'12</u>	<u>FY'13</u>	<u>Change</u>
Technology Hardware	\$52,794	\$109,250	\$56,456

➤ Routine PC replacements; two smart boards at Hiawatha; additional mini-computers – one for each 7th & 8th grade student at ADL; and piloting the use of iPads at Summit and Fleming.

	<u>FY'12</u>	<u>FY'13</u>	<u>Change</u>
Telephone Costs	\$74,947	\$62,887	(\$12,060)

➤ Long-term equipment lease paid off in April 2013.

	<u>FY'12</u>	<u>FY'13</u>	<u>Change</u>
Long Term Debt	\$176,770	\$168,542	(\$8,228)

➤ Long-term interest decreases each year. Bond defeasance revenue covers debt payment. The final year for debt and revenue is FY'16.

Total Increase of \$698,111

Technology Equipment

	Tech Eqmt (730)	Tech HW (734)	Comments & Totals
Hiawatha			
PCs (28)		\$19,600	Replacements
Smart Boards (2)		\$5,000	Tech budget only had 1 @ \$3.5K - added a 2nd @ \$1.5K; For world language & conf rm
Laptops (2)		\$2,000	Replacements
Wireless Access Points (2)		\$1,000	Provides 100% coverage in school
Printers (12)	\$4,800		Replacements to drive down per copy cost
Projectors (2)	\$1,500		
Hiawatha Total	\$6,300	\$27,600	\$33,900
Summit			
iPads (13)		\$7,150	Teams (grade-level, MAPE, etc.) will receive training & a schedule to access the iPads with students to inform the need for future purchases and PD
Wireless Access Points (3)		\$1,500	Provides 100% coverage in school
Projector (1)	\$750		
Summit Total	\$750	\$8,650	\$9,400
Fleming			
PCs (18)		\$12,600	Replacements
iPads (12)		\$6,600	1 per classroom teacher for direct instruction on smartboards, for formative assessment, and communication; may lead to transition from minis to iPads
Smart Board (1)		\$1,500	Replacement
Clicker Set (1)		\$1,200	Classroom response system
Printers (2)	\$800		
Wireless Access Points (2)		\$1,000	Provides 100% coverage in school
Fleming Total	\$800	\$22,900	\$23,700
ADL			
Minis (92)		\$50,600	Provides one mini for each 7th & 8th grader
Laptops (1)		\$1,000	
Wireless Access Points (22)		\$11,000	Provides 100% coverage in school
Wireless Controller (1)		\$15,000	Within school vs. having data travel to EHS - increased speed
ADL Total	\$0	\$77,600	\$77,600
Miscellaneous			
Phone Equipment	\$2,400		
UPS (2)		\$2,000	
Switch (3)		\$21,000	
Servers (3)		\$10,500	
Total Miscellaneous	\$2,400	\$33,500	\$35,900
Total	\$10,250	\$170,250	\$180,500
Less Capital Plan Funds		\$61,000	\$61,000
General Fund Totals	\$10,250	\$109,250	\$119,500

Homestead Tax Rate (K-8)

Description	FY'12	FY'13	Change	% Change
Total Expense Budget	\$15,743,203	\$16,441,314	\$698,111	4.4%
- Non-Tax Revenue	\$2,822,206	\$3,250,968	\$428,762	15.2%
+ Capital Fund Contribution	\$100,000	\$100,000	\$0	0.0%
= Education Spending (ES)	\$13,020,997	\$13,290,346	\$269,349	2.1%
÷ Equalized Pupil (EP) Count	1,013.26	1,027.27	14.01	1.4%
= ES/EP	\$12,850.60	\$12,937.54	\$86.94	0.7%
÷ Base Education Amount	\$8,544.00	\$8,723.00	\$179.00	2.1%
= District Spending Adj (ES/EP / Base Ed Amt)	150.405%	148.315%	-2.090%	

Legislature sets – assumes 1 yr of inflation

Essex Junction K-8 Homestead Tax Rate	FY'12	FY'13	Change
Base Homestead Tax Rate	\$0.870	\$0.890	\$0.020
× District Spending Adj (ES/EP / Base Ed Amt)	150.405%	148.315%	-2.090%
= EJSD Estimated Equalized Homestead Rate	\$1.3085	\$1.3200	\$0.0115
÷ Common Level of Appraisal	99.76%	100.990%	1.23%
= EJSD Estimated Actual Homestead Rate	\$1.3116	\$1.3071	(\$0.005)
× % of Equalized Pupils in K-8	64.110%	65.600%	1.490%
= K-8 Estimated Actual Homestead Rate	\$0.8409	\$0.8574	\$0.0165
			\$16.53

Impact per \$100K in property

➤ Note: Tax Commissioner's recommendation was \$0.87 assuming State-wide education spending remains level with FY'12, but the Legislature will ultimately set the rate. The Base Education Amount could also be set higher. These assumptions seem to be the standard among most school districts.

Income Sensitivity Rate (K-8)

Essex Junction K-8 Income Sensitivity Rate	FY'12	FY'13	Change
Base Rate	1.80%	1.80%	0.00%
× District Spending Adj (ES/EP / Base Ed Amt)	150.405%	148.315%	-2.090%
= EJSD Income Sensitivity Rate	2.71%	2.67%	-0.04%
× % of Equalized Pupils in K-8	64.11%	65.60%	1.49%
= K-8 Income Sensitivity Rate	1.74%	1.75%	0.01%
			\$5.00

Impact for \$50K in
Income

Homestead Tax Rate (K-12)

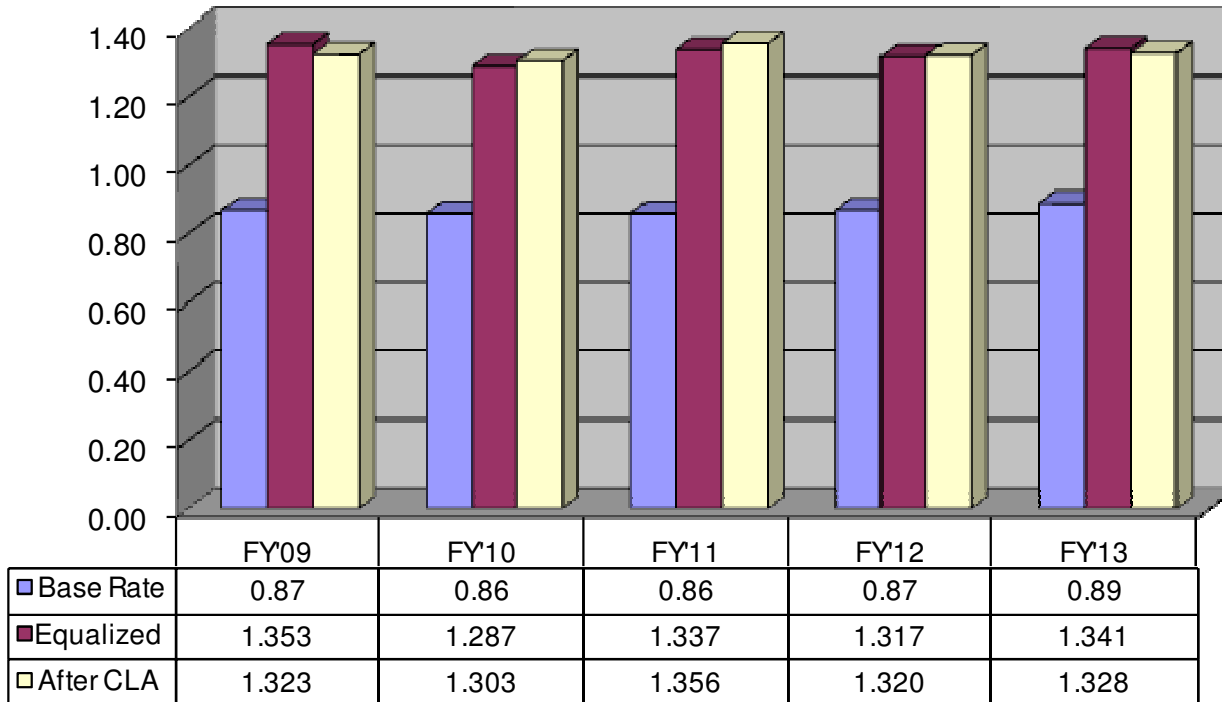

Essex Junction K-12 Homestead Tax Rate	FY'12	FY'13	Change
EJSD K-8 Rate	\$0.8409	\$0.8574	\$0.0165
+ U#46 9-12 Rate*	\$0.4789	\$0.4701	(\$0.0088)
= Estimated Actual K-12 Homestead Rate	\$1.3198	\$1.3275	\$0.0077

* Gr 9-12 Equalized Homestead Rate from U#46 approved budget

Impact per \$100K in property

Income Sensitivity Tax Rate (K-12)

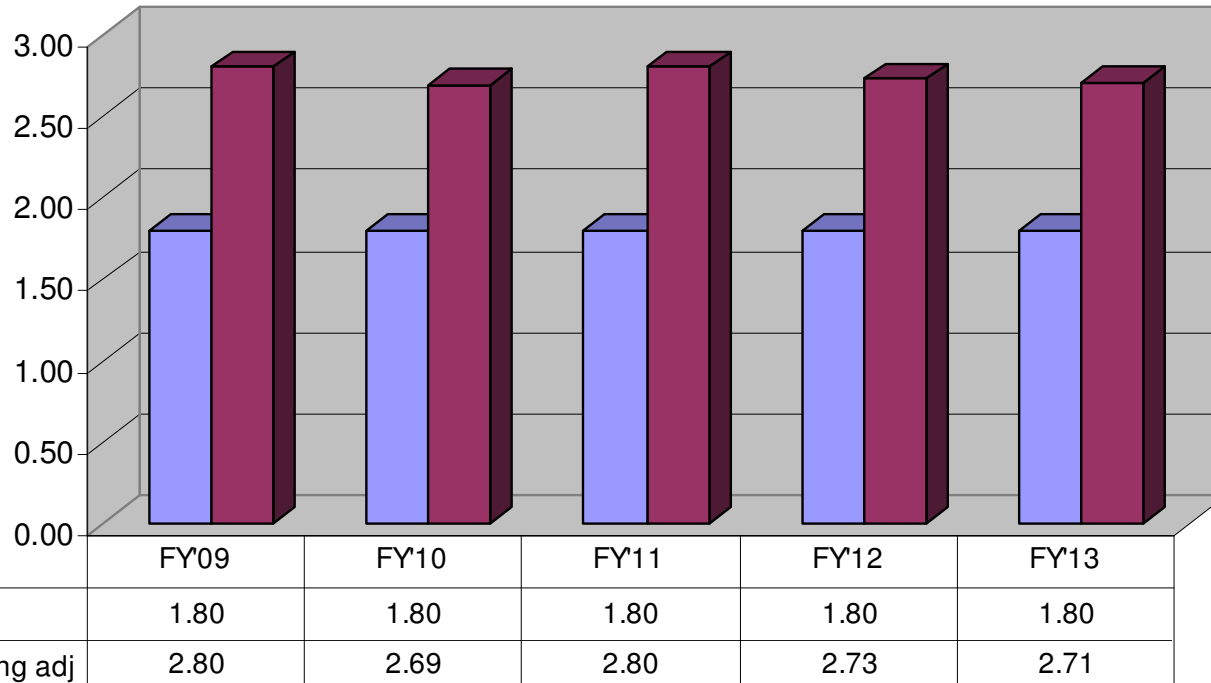

Essex Junction K-12 Income Sensitivity Rate	FY'12	FY'13	Change
EJSD K-8 Rate	1.74%	1.75%	0.01%
+ U#46 9-12 Rate*	0.99%	0.96%	-0.03%
Essex Junction K-12 Income Sensitivity Rate	2.73%	2.71%	-0.02%

* Gr 9-12 Income Sensitivity Rate from U#46 approved budget

Impact for \$50K in Income

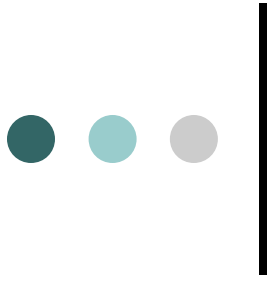

EJSD Capital Fund



EJSD Capital Plan Overview

- Funded with District's Contingency and Capital Reserve Fund
- Allowed for capital investments related to safety, accessibility, preventative & capital maintenance and environmental enhancements/ efficiencies with no tax implications
- Significant withdrawals from the Contingency and Capital Construction Fund in FY07 & 08 due to increased emphasis on capital investments
- To extend life of the fund, the Capital Plan was significantly scaled back beginning in FY09 and an article was presented/ approved to partially fund projects with \$100K in new tax revenues

EJSD Capital Plan

Title	Site	Description	FY'12	FY'13	FY'14	FY'15	FY'16
Safety & Security	DISTRICT	Security	\$6,000	\$7,000	\$7,000	\$7,000	\$8,000
		Doors	\$10,000	\$7,000	\$7,000		\$7,000
Safety & Security Total			\$16,000	\$14,000	\$14,000	\$7,000	\$15,000
Accessibility Improvement Issues	DISTRICT	Parking Lot & Sidewalk Maintenance			\$20,000	\$20,000	\$25,000
	FLEMING	Driveway & Parking Lot			\$50,000	\$42,000	
Accessibility Improvement Issues Total			\$0	\$0	\$70,000	\$62,000	\$25,000
Preventative & Routine Capital Maintenance	DISTRICT	Food Service Equipment		\$25,000		\$35,000	
		Floors (Tile/Carpeting)	\$15,000	\$15,000	\$15,000	\$15,000	\$15,000
		Roof Repairs and Maintenance		\$25,000	\$25,000	\$25,000	\$80,000
		Heat Plant Repairs and Maintenance	\$10,000	\$10,000	\$10,000	\$10,000	\$10,000
	FLEMING	Stage Curtain			\$25,000		
Preventative & Routine Capital Maintenance Total			\$25,000	\$75,000	\$75,000	\$85,000	\$105,000
Environment Enhancements/Efficiencies	DISTRICT	Computer Replacement Program	\$50,000	\$61,000	\$55,000	\$55,000	\$60,000
		Energy Conservation Efforts	\$20,000		\$20,000	\$20,000	\$20,000
	ADL	Replacement Lockers - Gym		\$32,000			
	HIAWATHA	Building Renovation & Vestibule	\$150,000	\$45,000			
Remove Tennis Court			\$10,000				
Environment Enhancements/Efficiencies Total			\$220,000	\$148,000	\$75,000	\$75,000	\$80,000
Grand Total			\$261,000	\$237,000	\$234,000	\$229,000	\$225,000

Security: For replacement cameras

Doors: Replacement/Repair of exterior doors district wide - Summit

Parking Lots & Sidewalk Maintenance: No major requirements - set aside for future repairs

Fleming Loop - Driveway & Parking: One-way, clockwise loop to address traffic issues raised in independent, long-term study.

Food Service Equipment: Commercial (captive air - energy efficient) kitchen hood with fire suppression at ADL in FY'13; Replacement truck in FY'15

Floors: For repair/replacement of flooring at any EJ school - Summit re-tile (\$4.8K) and Fleming carpet (\$5.8K)

Roof Repairs & Maintenance: For maintenance of roofs at any EJ school - no pressing reqmts, will set aside for future, costly repairs

Heat Plant Repairs & Maintenance: To replace burners or pumps as needed at any EJ school - 11 boilers with 4-9 sections each

Fleming Stage Curtain: Anticipated need in near future

Computer Replacement Program: 3 Switches (\$21K); 3 Servers (\$10.5K); 29 Wireless Access Points (\$14.5K); 1 Wireless Access Controller (\$15K)

Energy Conservation Efforts: For energy conservation projects at any EJ school

ADL Lockers: Replaces lockers in both the boy's and girl's gym locker rooms

Hiawatha Renovation: Main entrance & front office suite accomplished in FY'12; Renovate itinerant staff room in FY'13.

Hiawatha Tennis Courts: Outdoor tennis courts are in disrepair and not needed - convert to green space



ADL Lockers



Hiawatha Office Renovation



Hiawatha Office Renovation

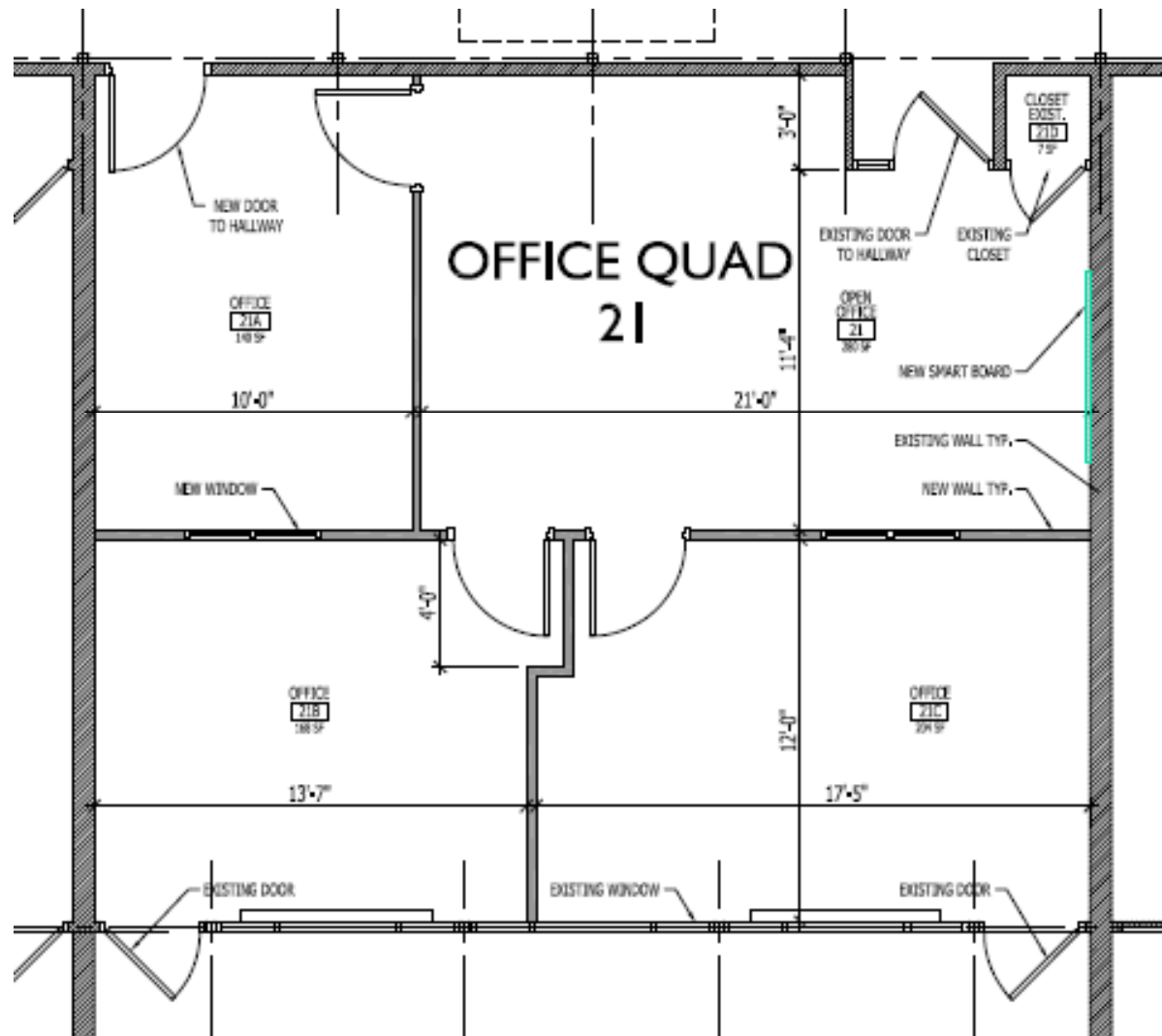



EJSD Capital Fund

Investment Status (Dec 31, 2011)

Capital Reserve Fund

\$	853,849	Certificate of Deposit (7/11/11 - 7/10/12)
\$	76,414	Cash & Equivalents
\$	237,000	Proposed FY'13 budget in Capital Plan
\$	693,263	Balance Available after FY'13 (not including Impact Fees or future interest)

- To support the current plan, taxes need to be raised for the Capital Fund starting in FY'17.
- To extend the life of the Capital Reserve and ease transition to raising Capital Funds through taxes, the Board could once again propose an article to raise \$100K in taxes to complement the Capital Reserve Funds.

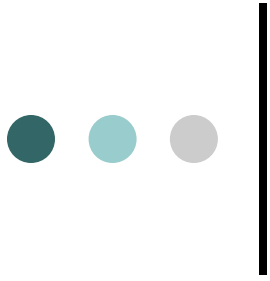

EJRP General Fund



EJRP Achievements

■ Facilities

- Cascade basketball & tennis courts were resurfaced and mini-hoops are being installed on the small court
- Trails master plan was developed for Maple Street Park
- Community volunteers spent two days preparing the future site of the Maple Street Bike Park
- Signed licensing agreement with the State which will allow for construction of a Dog Park at the West Street Complex
- West Street Community Gardens were expanded to include 40 new garden plots for the summer of 2012
- This spring the new pavilion will be enhanced with electricity & lighting; camp spaces will be completed; and a new maintenance shed will be constructed

■ Programs

- Preschool – Implemented Act 62 agreements with CCSU, CSSU, and ETSD; Moved to online student portfolios with Gold Creative Curriculum assessments; Program is full and has a waitlist
- Aspire Community Studio – Opened in January; Initial sessions of Zumba, Yoga, fitness, & dance have over 220 registered participants
- Winter Swim Lessons – Pilot program began this year with 150 children swimming at two pools in the 1st session
- Village Kids – Supports 140 children with after school care – nearly 25% of Hiawatha & Summit students participate
- Intramural Sports – Pilot program began and is showing strong support by Fleming students

■ Staff/Recreation Advisory Council (RecPAC)

- RecPAC members Wendy Johnson & Bridget Meyer were recognized by the VT Recreation & Parks Association with the annual Friends of Recreation Award
- Christina Poland (Preschool Coordinator) attended NAEYC and VAEYC conferences and is working toward a Masters in Early Childhood Education
- Harlan Smith (Head of Facilities & Grounds) attended Supervisors' Management School and renewed his certification as a Certified Playground Safety Inspector
- Mark Brislin & Ryan Hegreness (Assistant Directors) attended the National Recreation & Parks Association Congress
- Brad Luck (Director) is working toward a Masters in Public Administration at UVM

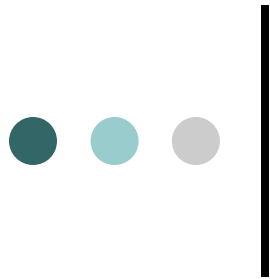

Significant Budget Changes

Revenues:

	<u>FY'12</u>	<u>FY'13</u>	<u>Change</u>
Fund Balance	\$98,000	\$135,000	\$37,000

➤ FY'11 available fund balance of \$135K is higher than the prior year. An increase in fund balance this year could be followed by a decrease for FY'14 (creating a challenge to keep the tax rate level). Therefore, EJRP plans to invest nearly \$22K in one-time equipment purchases which will not be required in FY'14.

	<u>FY'12</u>	<u>FY'13</u>	<u>Change</u>
Licensed Childcare Fees	\$515,551	\$523,625	\$8,074

➤ Increased revenue based on Preschool and Village Kids projected enrollment. More than offsets a decrease in Camp Maple Street – reduced camp from 10 to 9 weeks.

	<u>FY'12</u>	<u>FY'13</u>	<u>Change</u>
Property Tax Revenue	\$598,554	\$604,857	\$6,303

➤ Assumes same tax rate, but minor (0.5%) increase in Grand List value.

Total Increase of \$50,592



Significant Budget Changes

Investments:

	<u>FY'12</u>	<u>FY'13</u>	<u>Change</u>
Benefits	\$181,288	\$208,873	\$27,585

➤ Largely driven by the proposal to combine Village Kids Coordinators with EJSD Teaching Assistant positions which results in the need to budget for health benefits (\$20.1K). Fortunate that health premiums only increased of 3.5% (\$1.2K). The self-insured dental program increased rates by 6% (\$2.4K) – 1st increase in 10 years. Tuition reimbursement is based on inflated FY'11 actual expense (\$2.3K).

	<u>FY'12</u>	<u>FY'13</u>	<u>Change</u>
Parks, Pools, & Facilities - Ops & Maint	\$46,324	\$77,921	\$31,597
Electricity	\$24,971	\$27,734	\$2,763
Equipment	\$7,853	\$29,637	\$21,784
General Maintenance	\$12,000	\$16,800	\$4,800
Rental of Equipment	\$1,500	\$3,750	\$2,250

- Operations & Maintenance Increases:
- Electricity based on 3-yr average usage and 7% rate increase over FY'11.
 - Equipment increase is for one-time investments to improve the pool (flooring, fencing, etc.).
 - General maintenance increase is associated with air duct cleaning and painting the main building.
 - Equipment rental increase is also associated with painting – rental of lift.



Significant Budget Changes

	<u>FY'12</u>	<u>FY'13</u>	<u>Change</u>
Field Trips	\$25,785	\$28,950	\$3,165

➤ Increase based on an estimated 10 field trips per year for each Village Kids location and adding field trips to vacation camps.

	<u>FY'12</u>	<u>FY'13</u>	<u>Change</u>
Long Term Interest	\$47,022	\$35,094	(\$11,928)

➤ Interest on long-term debt decreases each year. This year's decrease is larger than usual because the Vermont Municipal Bond Bank issued a refunding bond at a lower interest rate. Debt is paid off in FY'20.

Total Increase of \$50,592



SU Assessment Share

	EJ Portion of SU Assess	Only Applicable to EJSD	General (Certified & Prof Staff FTE)		Central & Fiscal Service		Info Tech (# of Computers)		Assessment Totals	
			EJSD	EJRP	EJSD	EJRP	EJSD	EJRP	EJSD	EJRP
Sum of FY'13 PROPOSED		100.00%	94.01%	5.99%	80.00%	20.00%	98.42%	1.58%	92.37%	7.63%
Central Services	\$88,860				\$71,088	\$17,772			\$71,088	\$17,772
Enterprise Project	\$15,073		\$14,170	\$903					\$14,170	\$903
Executive Administrative Svcs	\$139,940		\$131,559	\$8,381					\$131,559	\$8,381
Fiscal Services	\$108,077				\$86,462	\$21,615			\$86,462	\$21,615
Food Service	\$26,406	\$26,406							\$26,406	\$0
Information Technology	\$292,508						\$287,886	\$4,622	\$287,886	\$4,622
Instr & Curr Development	\$64,770		\$60,891	\$3,879					\$60,891	\$3,879
Educational Technologist	\$37,131	\$37,131							\$37,131	\$0
Legal Services	\$36,254		\$34,083	\$2,171					\$34,083	\$2,171
Operation & Maint of Plant	\$56,817		\$53,414	\$3,403					\$53,414	\$3,403
Personnel Services	\$99,153		\$93,215	\$5,938					\$93,215	\$5,938
Special Area Admin Svces	\$55,931		\$52,581	\$3,350					\$52,581	\$3,350
Local Revenue Credit	(\$53,958)		(\$50,726)	(\$3,232)					(\$50,726)	(\$3,232)
Total	\$966,962	\$63,537	\$389,187	\$24,793	\$157,550	\$39,387	\$287,886	\$4,622	\$898,160	\$68,802
Adjustment for Treasurer Services									(\$5,000)	\$5,000
Adjusted Total									\$893,160	\$73,802

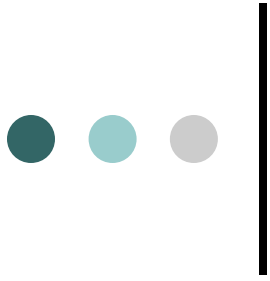

EJRP Capital Fund



EJRP Capital Fund

Title	Description	FY'12	FY'13	FY'14	FY'15	FY'16
Life Safety & Security	Playground Equipment			\$10,000		
	Resurfacing	\$24,000	\$10,000	\$6,500		\$3,000
Life Safety & Security Total		\$24,000	\$10,000	\$16,500	\$0	\$3,000
Preventative & Routine Maintenance	Fencing				\$15,000	\$45,000
	Parking Lot			\$4,000		
	Maintenance Equipment		\$21,000	\$12,000	\$22,000	
Preventative & Routine Capital Maintenance Total		\$0	\$21,000	\$16,000	\$37,000	\$45,000
Environment Enhancements	Park Amenities	\$30,000	\$18,000	\$11,500	\$32,500	\$5,500
	Pedestrian Paths	\$15,500	\$20,500	\$25,500		\$16,000
	Landscaping	\$5,500	\$5,500	\$5,500	\$5,500	\$5,500
Environment Enhancements Total		\$51,000	\$44,000	\$42,500	\$38,000	\$27,000
Grand Total		\$75,000	\$75,000	\$75,000	\$75,000	\$75,000

Playground Equipment: FY'14 - Maple St requirements

Resurfacing: FY'13 - Maple St basketball/skatepark/playground; FY'14 - Maple St tennis courts

Fencing: FY'15 - B Field backstop & baseline; FY'16 - Seman Field backstop & baseline, Cascade tennis court, backstop & baseline

Parking Lot: FY'14 - Cascade re-coat

Maintenance Equipment: FY'13 - park utility vehicle & zero turn mower for Cascade; FY'14 - replacement truck; FY'15 - mower

Park Amenities: FY'13 - Cascade shed, pool equipment; FY'14 - Concessions & Pool equipment; FY'15 - Pool house bathrooms, Pool water feature, Pool equipment, Cascade - general improvements & replacement equipment (\$4.5K)

Pedestrian Paths: FY'13 - Repair of existing paths & creation of new paths at Maple St; FY'14 - Cascade path extended & continue Maple St paths; FY'16 - Maple St paths continued

Landscaping: Continued development of landscape plan and implementation at Maple St



Summary

■ EJSD General Fund

- Total budget = **\$16,441,314**
- Education Spending shows an **increase** of \$269,349 or **2.1%**, but lower than FY'11
- Includes larger than usual budget-to-budget salary increases

■ EJSD Capital Plan

- Total budget = **\$237,000** – reflects a **decrease** of \$24,000 or **-9.2%**

■ EJRP General Fund

- Total budget = **\$1,559,558**
- Represents an **increase** of \$50,592 or **3.4%**
- Constrained by **level tax rate** (\$0.0651)
- About 60% of the budget is funded by program revenues

■ EJRP Capital Plan

- Total budget = **\$75,000** – held at current level



Budget Articles

■ **EJSD**

- Approve total budget of \$16,441,314
- Commit \$198,000 for less than anticipated revenue in future years
– to stabilize future tax rates
- Appropriate \$100,000 to supplement the Capital Reserve Fund

■ **EJRP**

- Appropriate \$604,857 of tax revenues necessary to support EJRP
- Appropriate \$75,000 for the EJRP Capital Reserve Fund



EJSD Budget – The Road Ahead

Feb 9 – Budget Work Session

Mar 19 – Board Meeting (budget presentation)

Apr 9 – Informational Hearing

Apr 10 – Budget Vote

Informational Hearing

Monday, April 9, 2012
6:30 p.m.

- Essex High School
Cafeteria

Don't Forget to Vote

Tuesday, April 10, 2012

7:00 a.m. – 7:00 p.m.

- Essex High School
(Village Residents)

- Essex Middle School
(Town Residents)

Art by Eva Joly, Grade 4